

Job Name:	
Submitted By:	



Submittal Sheet For:	<b>WT018GLUI17HLD / YN018GLUI17RPD</b>
----------------------	--

Date \_\_\_\_\_

Ref. \_\_\_\_\_

## Wall-Mounted Ductless 17SEER Inverter Heat Pump

System Full Set Model: **WYT018GLUI17RL**

AHRI Reference Number: **217048736**

### Cooling Mode Performance

Rated Cooling	17,000 BTU/hr
Ambient Range	54°F ~ 122°F
SEER Rating	17 BTU/W·h
EER2 Rating	9.5 BTU/W·h

\* 100% Capacity @ Indoor DB 80°F/WB 67°F / m.w. 16' lineset

### Heating Mode Performance

Rated Heating	16,500 BTU/hr
Ambient Range	5°F ~ 86°F
HSPF2 IV (V)	8.5 (7.2) BTU/W·h
COP	3.2 W/W

\* High Heat (47°F) = 16,500 BTU / Low Heat (17°F) = 10,000 BTU / COP (5°F) = 1.80



Wall-Mounted Indoor Unit



Outdoor Condensing Unit



16' Installation Kit (Pipe + Cable)



Handheld Remote Controller

### Electrical Information

Rated Input (W)	Cooling	Heating
	1,770	1,440
Rated Current (A)	7.7	6.3
Breaker Needed	20A (Double-Pole)	
Power Supply	208~230V, 1Ph, 60Hz	

### Piping and Refrigerant

Liquid Line (OD)	1/4"
Suction Line (OD)	3/8"
Refrigerant Precharge	R32 (16 ft.)
Max Length/Height Diff.	50 ft. / 33 ft.

This combination is AHRI/ETL/ISO certified.



### Interior Unit (Air Handler) Specifications

Type	Heat Pump
Sound Level (dBA)	49 (Turbo) / 45 (Hi) / 40 (Med) / 34 (Lo) / 32 (Mute)
Auto Air Circulation	2-Way Louver (Up-Down + Left-Right)
Dimensions (WDH)	35"-3/4 x 8"-1/8 x 11"-1/2
Weight (lbs)	20.9

### Exterior Unit (Condenser) Specifications

Sound Level (dBA)	57
Recommended Room Size	500~750 Sq. ft.
Minimum Room Size	27 Sq. ft.
Compressor	Inverter-Driven Rotary
Dimensions (WDH)	31"-7/8 x 12" x 21"-5/8
Weight (lbs)	57.3

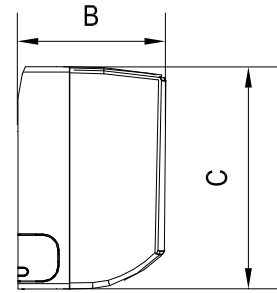
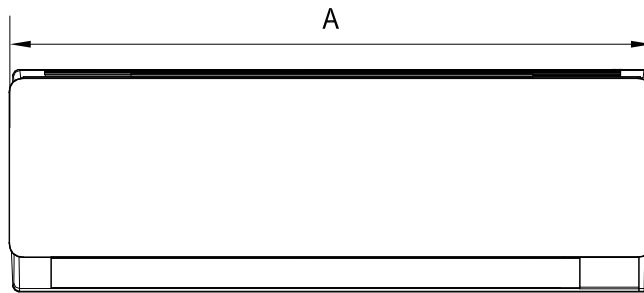
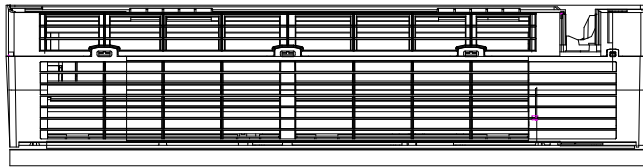

Model	A	B	C
WT018GLUI17HLD	910 mm 35-3/4"	205 mm 8-1/8"	292 mm 11-1/2"

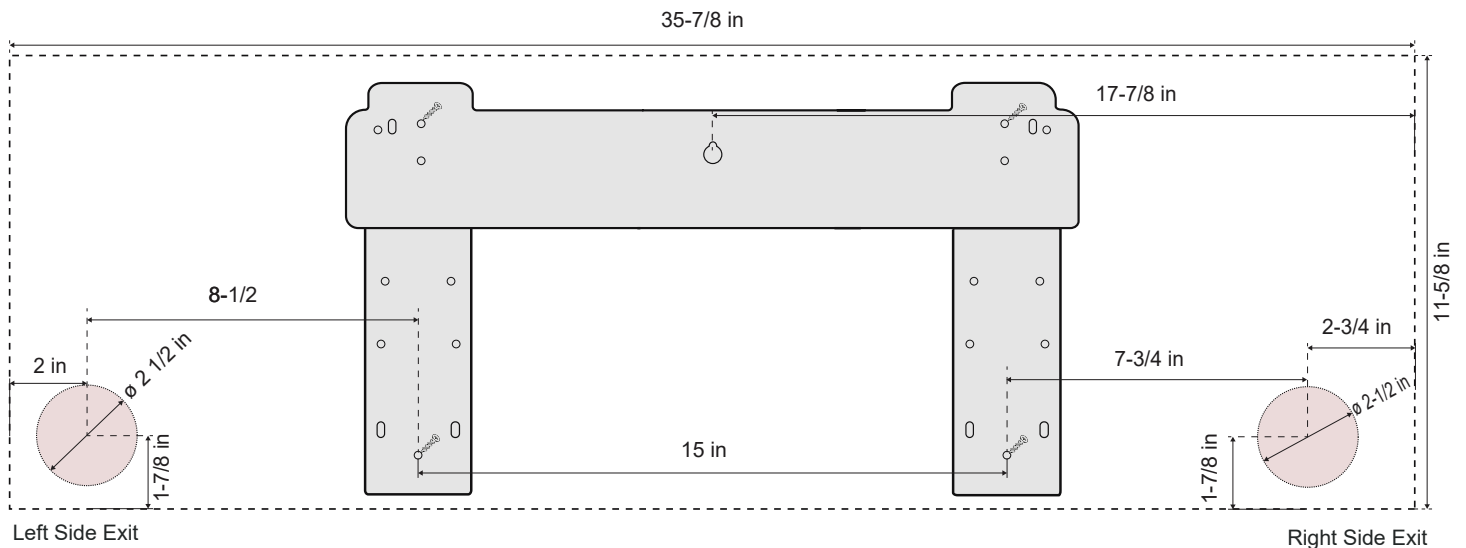

(For 18K BTU Systems)  
All Distances in Inches

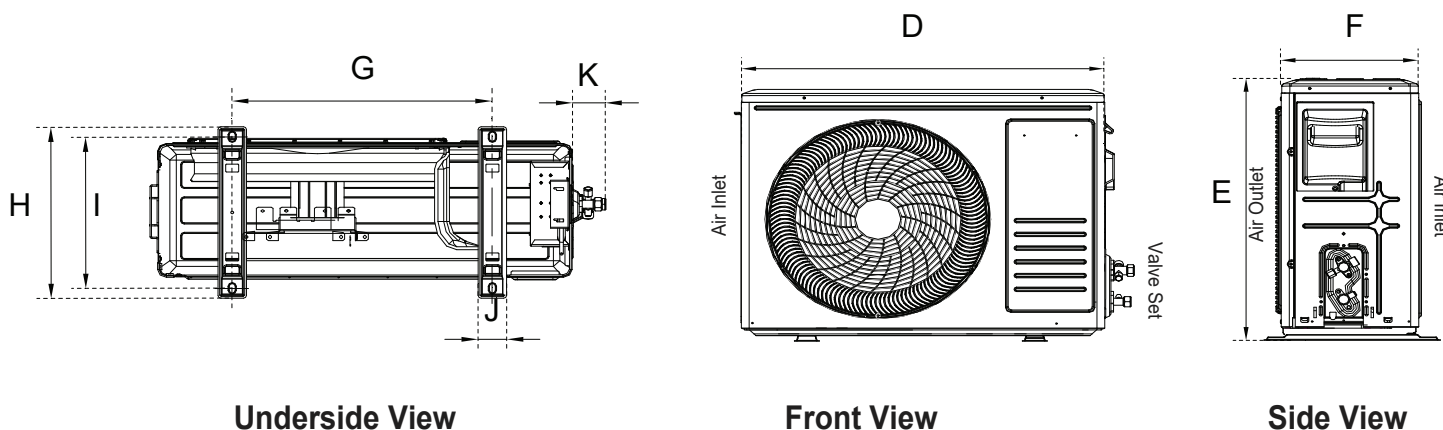

Model	D	E	F	G	H	I	J	K
YN018GLUI17RPD	726 mm	549 mm	252 mm	433.8 mm	305 mm	278 mm	48 mm	52 mm
	28-5/8"	21-5/8"	9-7/8"	17-1/8"	12"	10-7/8"	1-3/8"	2"

### Warranty Information and Length



Complete warranty details are available with the vendor or online at <https://www.pdhvac.com/support/warranty/>. This high-quality system is eligible for up to a 5-year limited warranty on the compressor, and 5 years on other internal parts. To qualify for this warranty, the system must be installed within 90 days and registered properly. All other installations that are unregistered qualify for only 1-year parts/compressor warranty.

### Outstanding Features

- LED Display
- Energy Saving
- Ultra-Thin Design
- Dual Drain Options
- Customizable Timer
- Eco-Friendly Refrigerant
- Whisper-Quiet Operation
- Power Loss Memory Recovery

### Available Accessories

Part Number	Description
IKT-LCVR4P-KIT	<i>Decorative PVC Line Cover Kit</i>
IKT-LNBR-1/4-3/8	<i>BendAid Flexible Easy Bender Kit</i>
BRK-FRM-C-2P	<i>Folding Mounting Bracket w/ Leveler</i>
IKT-UVL32UL-AG	<i>UVC Bacterial Disinfection Kit</i>
IKT-SURPRK-DV2	<i>Ultimate Surge and Power Protection</i>