

Job Name:	
Submitted By:	



Submittal Sheet For:	<b>WT024GLUI17HLD / YN024GLUI17RPD</b>
----------------------	--

Date \_\_\_\_\_

Ref. \_\_\_\_\_

**Wall-Mounted Ductless 17SEER Inverter Heat Pump**

System Full Set Model: **WYT024GLUI17RL**

AHRI Reference Number: **217048737**

**Cooling Mode Performance**

Rated Cooling	23,000 BTU/hr
Ambient Range	54°F ~ 122°F
SEER Rating	17 BTU/W·h
EER Rating	9.5 BTU/W·h

\* 100% Capacity @ Indoor DB 80°F/WB 67°F / m.w. 16' lineset

**Heating Mode Performance**

Rated Heating	22,400 BTU/hr
Ambient Range	5°F ~ 86°F
HSPF2 IV (V)	9.5 (8.5) BTU/W·h
COP	3.3 W/W

\* High Heat (47°F) = 22,400 BTU / Low Heat (17°F) = 13,500 BTU / COP (5°F) = 1.80



Wall-Mounted Indoor Unit



Outdoor Condensing Unit



16' Installation Kit (Pipe + Cable)



Handheld Remote Controller

**Electrical Information**

Rated Input (W)	Cooling	Heating
	2,365	1,900
Rated Current (A)	10.3	8.4
Breaker Needed	25A (Double-Pole)	
Power Supply	208~230V, 1 Ph, 60Hz	

**Piping and Refrigerant**

Liquid Line (OD)	1/4"
Suction Line (OD)	1/2"
Refrigerant Precharge	R32 (16 ft.)
Max Length/Height Diff.	65 ft. / 50 ft.

This combination is AHRI/ETL/ISO certified.



**Interior Unit (Air Handler) Specifications**

Type	Heat Pump
Sound Level (dBA)	50 (Turbo) / 48 (Hi) / 46 (Med) / 40 (Lo) / 37 (Mute)
Auto Air Circulation	2-Way Louver (Up-Down + Left-Right)
Dimensions (WDH)	39"-3/4 x 8"-3/4 x 12"-3/8
Weight (lbs)	26.5

**Exterior Unit (Condenser) Specifications**

Sound Level (dBA)	56
Recommended Room Size	750~1,000 Sq. ft.
Minimum Room Size	41 Sq. ft.
Compressor	Inverter-Driven Rotary
Dimensions (WDH)	34" x 13"-3/4 x 23"-5/8
Weight (lbs)	70.5

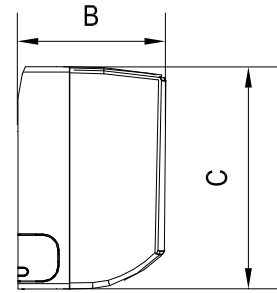
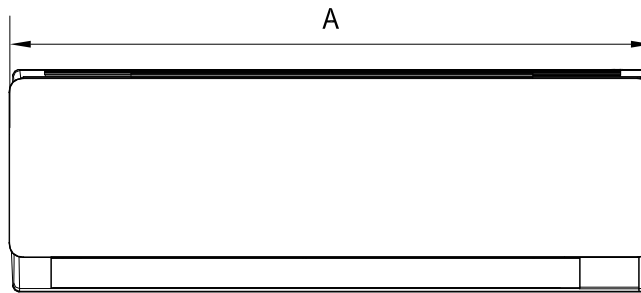
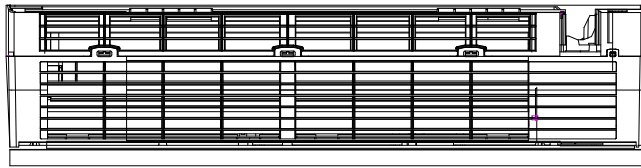

Model	A	B	C
WT024GLUI17HLD	1,010 mm 39-3/4"	315 mm 12-3/8"	220 mm 8-3/4"

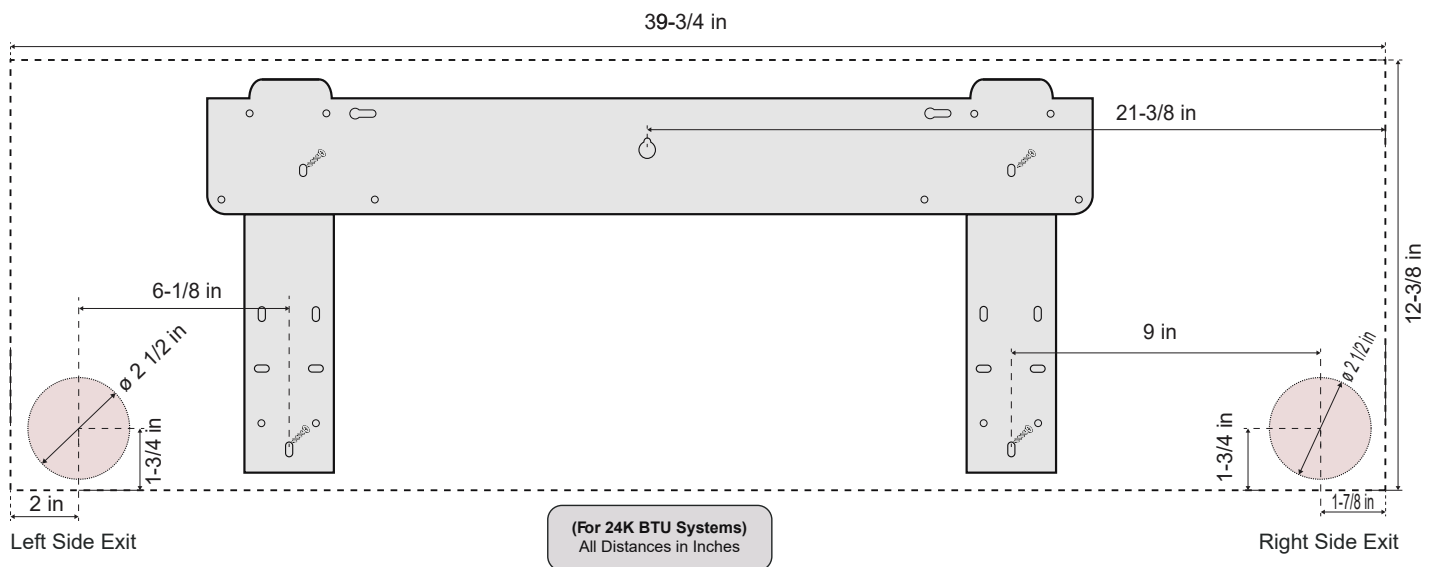

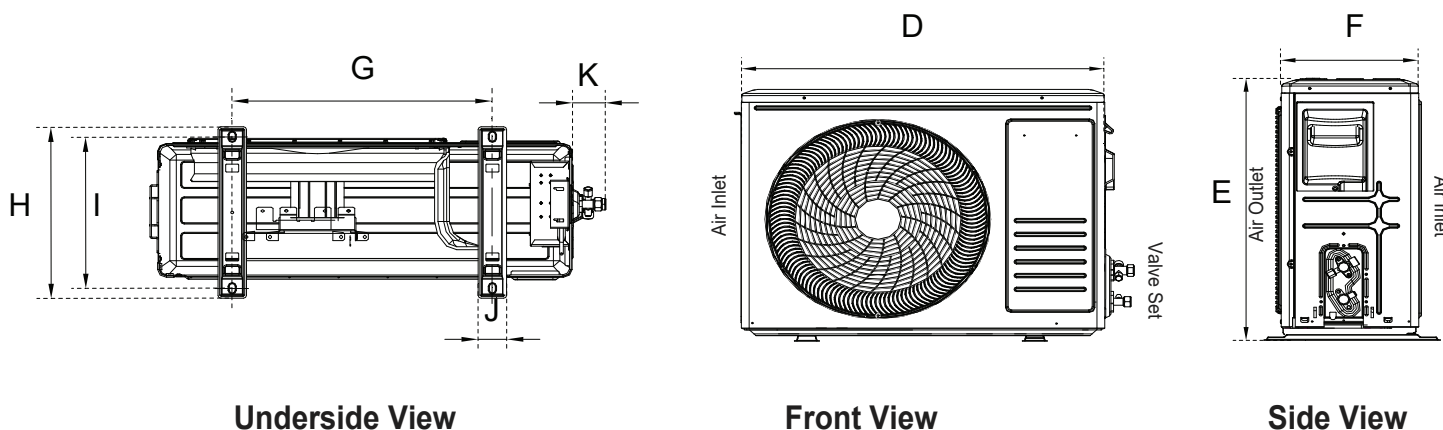

Model	D	E	F	G	H	I	J	K
YN024GLUI17RPD	780 mm	602 mm	288 mm	516 mm	349 mm	314 mm	54 mm	57 mm
	30-3/4"	23-3/4"	11-1/4"	20-1/4"	13-3/4"	12-3/8"	2-1/8"	2-1/4"

## Warranty Information and Length



Complete warranty details are available with the vendor or online at <https://www.pdhvac.com/support/warranty/>. This high-quality system is eligible for up to a 5-year limited warranty on the compressor, and 5 years on other internal parts. To qualify for this warranty, the system must be installed within 90 days and registered properly. All other installations that are unregistered qualify for only 1-year parts/compressor warranty.

## Outstanding Features

- LED Display
- Energy Saving
- Ultra-Thin Design
- Dual Drain Options
- Customizable Timer
- Eco-Friendly Refrigerant
- Whisper-Quiet Operation
- Power Loss Memory Recovery

## Available Accessories

Part Number	Description
IKT-LCVR4P-KIT	<i>Decorative PVC Line Cover Kit</i>
IKT-LNBR-1/4-3/8	<i>BendAid Flexible Easy Bender Kit</i>
BRK-FRM-C-2P	<i>Folding Mounting Bracket w/ Leveler</i>
IKT-UVL32UL-AG	<i>UVC Bacterial Disinfection Kit</i>
IKT-SURPRK-DV2	<i>Ultimate Surge and Power Protection</i>