

Job Name:	
Submitted By:	



Submittal Sheet For:	WT036GLUI17HLD / YN036GLUI17RPD
----------------------	--

Date _____

Ref. _____

Wall-Mounted Ductless 17SEER Inverter Heat Pump

System Full Set Model: **WYT036GLUI17RL**

AHRI Reference Number: **217048738**

Cooling Mode Performance

Rated Cooling	35,000 BTU/hr
Ambient Range	54°F ~ 122°F
SEER Rating	17 BTU/W·h
EER Rating	9.5 BTU/W·h

* 100% Capacity @ Indoor DB 80°F/WB 67°F / m.w. 16" lineset

Heating Mode Performance

Rated Heating	35,400 BTU/hr
Ambient Range	5°F ~ 86°F
HSPF2 IV (V)	8.5 (7.5) BTU/W·h
COP	3.2 W/W

* High Heat (47°F) = 35,400 BTU / Low Heat (17°F) = 20,400 BTU / COP (5°F) = 1.80



Wall-Mounted Indoor Unit



Outdoor Condensing Unit



16' Installation Kit (Pipe + Cable)



Handheld Remote Controller

Electrical Information

Rated Input (W)	Cooling	Heating
	3,350	3,000
Rated Current (A)	14.6	13.2
Breaker Needed	35A (Double-Pole)	
Power Supply	208~230V, 1 Ph, 60Hz	

Piping and Refrigerant

Liquid Line (OD)	1/4"
Suction Line (OD)	5/8"
Refrigerant Precharge	R32 (16 ft.)
Max Length/Height Diff.	100 ft. / 65 ft.

This combination is AHRI/ETL/ISO certified.



Interior Unit (Air Handler) Specifications

Type	Heat Pump
Sound Level (dBA)	55 (Turbo) / 52 (Hi) / 46 (Med) / 41 (Lo) / 39 (Mute)
Auto Air Circulation	2-Way Louver (Up-Down + Left-Right)
Dimensions (WDH)	46"-7/8 x 10"-1/4 x 14"-1/4
Weight (lbs)	38.6

Exterior Unit (Condenser) Specifications

Sound Level (dBA)	63
Recommended Room Size	1,000~1,400 Sq. ft.
Minimum Room Size	63 Sq. ft.
Compressor	Inverter-Driven Rotary
Dimensions (WDH)	38"-1/2 x 16"-1/2 x 31"-5/8
Weight (lbs)	105.8

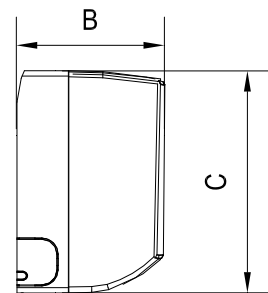
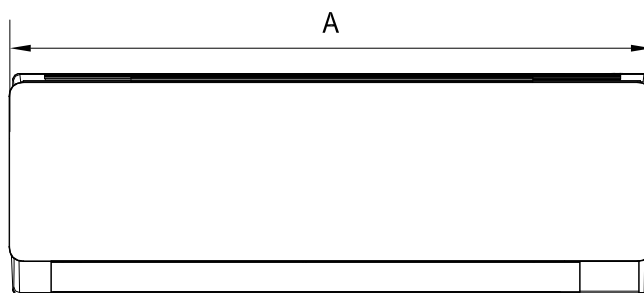
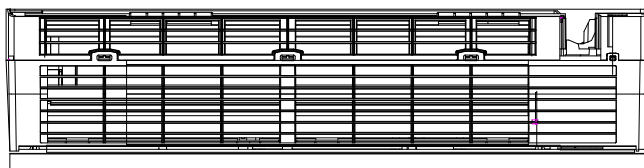

Model	A	B	C
WT036GLUI17HLD	1,186 mm 46-3/4"	340 mm 13-3/8"	268 mm 10-5/8"

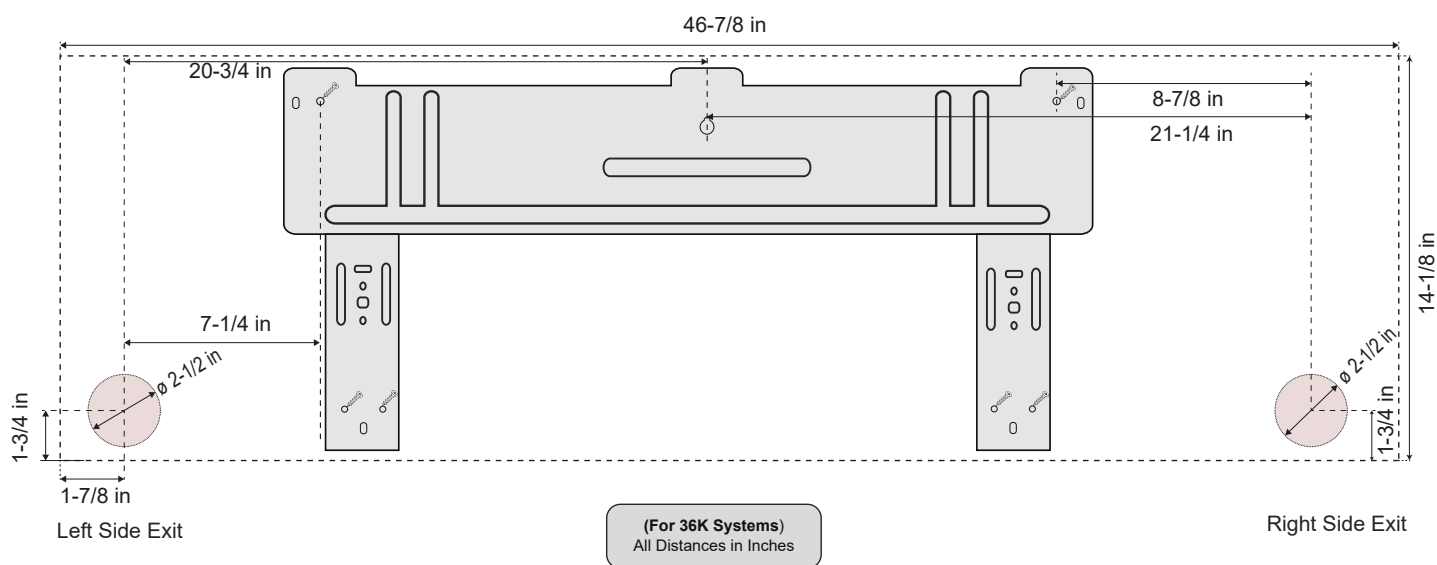

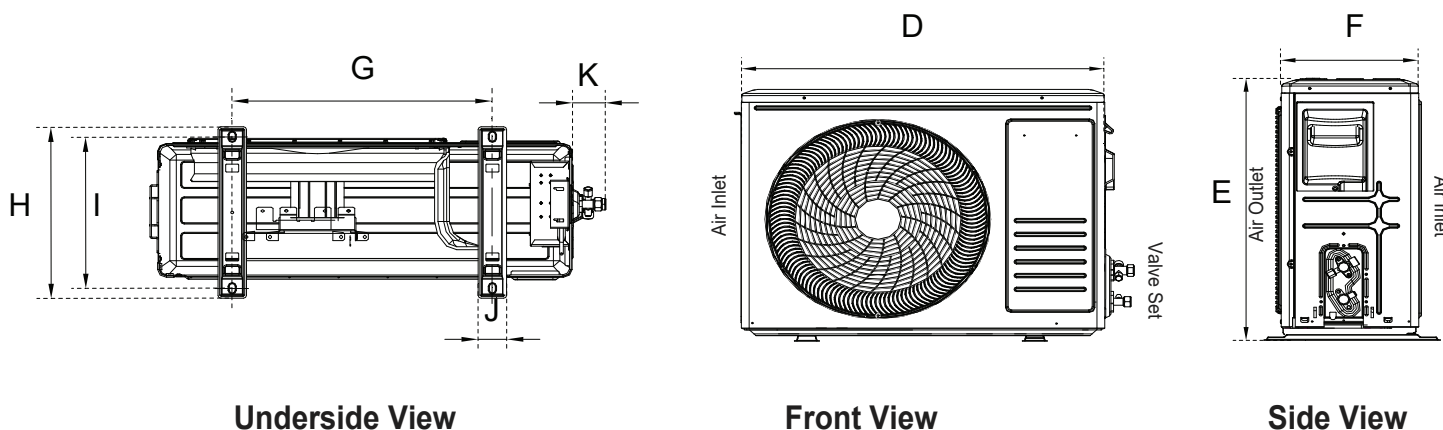

Model	D	E	F	G	H	I	J	K
YN036GLUI17RPD	910 mm	803 mm	359 mm	607 mm	421 mm	390 mm	60 mm	63 mm
	35-3/4"	31-5/8"	14-1/8"	23-7/8"	16-5/8"	15-3/8"	2-3/8"	2-1/2"

Warranty Information and Length



Complete warranty details are available with the vendor or online at <https://www.pdhvac.com/support/warranty/>. This high-quality system is eligible for up to a 5-year limited warranty on the compressor, and 5 years on other internal parts. To qualify for this warranty, the system must be installed within 90 days and registered properly. All other installations that are unregistered qualify for only 1-year parts/compressor warranty.

Outstanding Features

- LED Display
- Energy Saving
- Ultra-Thin Design
- Dual Drain Options
- Customizable Timer
- Eco-Friendly Refrigerant
- Whisper-Quiet Operation
- Power Loss Memory Recovery

Available Accessories

Part Number	Description
IKT-LCVR4P-KIT	<i>Decorative PVC Line Cover Kit</i>
TST-LCACWIFIKP	<i>Smart-WiFi Wired Wall Thermostat Kit</i>
BRK-FRM-C-2P	<i>Folding Mounting Bracket w/ Leveler</i>
IKT-UVL32UL-AG	<i>UVC Bacterial Disinfection Kit</i>
ICM517	<i>Ultimate Surge and Power Protection</i>