

Job Name:	
Submitted By:	



Submittal Sheet For:	WT012ALSI20HLF / YN012ALSI20RPF
----------------------	--

Date _____

Ref. _____

Wall-Mounted Ductless 20SEER Inverter Heat Pump

System Full Set Model: **WYT012ALSI20RL**

AHRI Reference Number: **217048742**

Cooling Mode Performance

Rated Cooling	12,000 BTU/hr
Ambient Range	5°F ~ 122°F
SEER Rating	20.5 BTU/W·h
EER Rating	10.5 BTU/W·h

* 100% Capacity @ Indoor DB 80°F/WB 67°F / m.w. 16" lineset

Heating Mode Performance

Rated Heating	12,000 BTU/hr
Ambient Range	-4°F ~ 86°F
HSPF2 IV (V)	9.5 (8.2) BTU/W·h
COP	3.41 W/W

*High Heat (47°F) = 12,000 BTU / Low Heat (17°F) = 7,500 BTU / COP(5°F) = 1.8



Wall-Mounted Indoor Unit



Outdoor Condensing Unit



16' Installation Kit (Pipe + Cable)



Handheld Remote Controller

Electrical Information

Rated Input (W)	Cooling	Heating
	1,050	1,030
Rated Current (A)	9.5	9.3
Breaker Needed	25A (Single-Pole)	
Power Supply	110~120V, 1Ph, 60Hz	

Piping and Refrigerant

Liquid Line (OD)	1/4"
Suction Line (OD)	3/8"
Refrigerant Precharge	R454b (16 ft.)
Max Length/Height Diff.	50 ft. / 33 ft.

This combination is AHRI/ETL/ISO certified.



Interior Unit (Air Handler) Specifications

Type	Heat Pump
Sound Level (dBA)	45 (Turbo) / 42 (Hi) / 35 (Med) / 30 (Lo) / 28 (Mute)
Auto Air Circulation	2-Way Louver (Up-Down + Left-Right)
Dimensions (WDH)	31"-7/8 x 8" x 11"-1/2
Weight (lbs)	19.8

Exterior Unit (Condenser) Specifications

Sound Level (dBA)	55
Recommended Room Size	350~500 Sq. ft.
Minimum Room Size	34 Sq. ft.
Compressor	Inverter-Driven (Rotary)
Dimensions (WDH)	31" x 11"-1/2 x 19"-3/8
Weight (lbs)	55.1

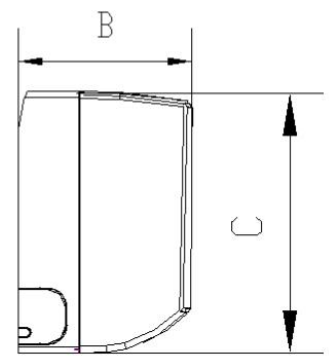
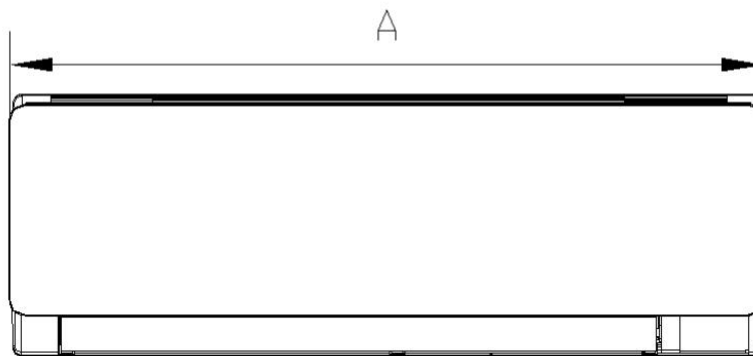
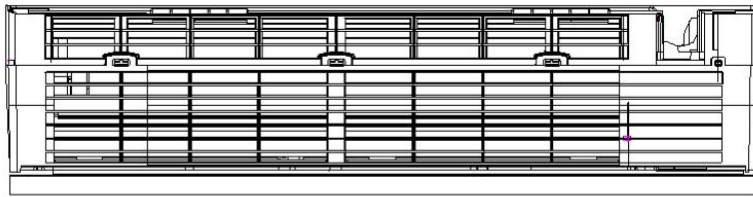

Model	A	B	C
WT012ALSI20HLF	811 mm 31-7/8"	292 mm 11-1/2"	202 mm 8"

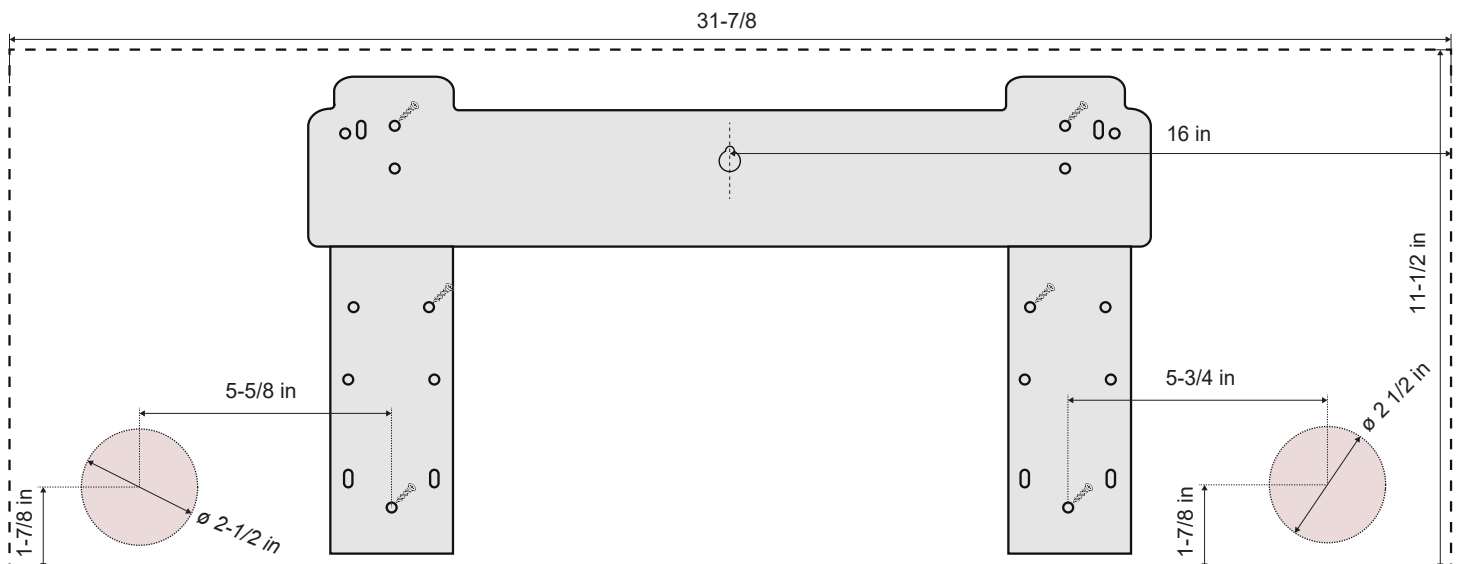

For 12K Systems
All Distances in Inches

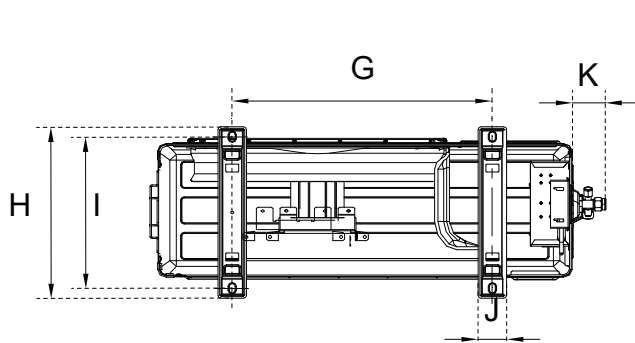

Underside View

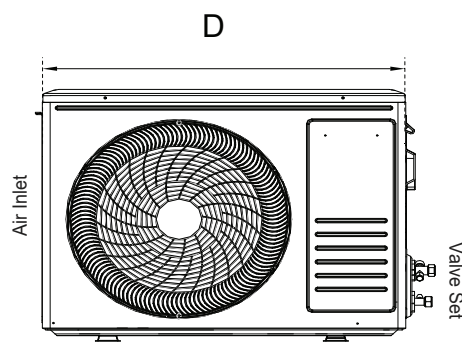

Front View

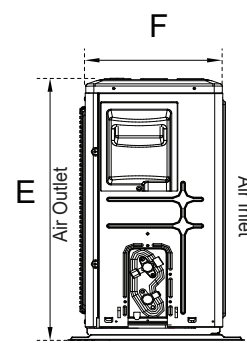

Side View

Model	D	E	F	G	H	I	J	K
YN012ALSI20RPF	712 mm	498 mm	234 mm	415 mm	290.4 mm	263 mm	48 mm	55.9 mm
	28"	19-5/8"	9-1/4"	16-3/8"	11-1/2"	10-3/8"	1-7/8"	2-1/4"

Warranty Information and Length



Complete warranty details are available with the vendor or online at <https://www.pdhvac.com/support/warranty/>. This high-quality system is eligible for up to a 5-year limited warranty on the compressor, and 5 years on other internal parts. To qualify for this warranty, the system must be installed within 90 days and registered properly. All other installations that are unregistered qualify for only 1-year parts/compressor warranty.

Outstanding Features

- LED Display
- Energy Saving
- Ultra-Thin Design
- Dual Drain Options
- Customizable Timer
- Eco-Friendly Refrigerant
- Whisper-Quiet Operation
- Power Loss Memory Recovery

Available Accessories

Part Number	Description
IKT-LCVR4P-KIT	<i>Decorative PVC Line Cover Kit</i>
IKT-LNBR-1/4-3/8	<i>BendAid Flexible Easy Bender Kit</i>
BRK-FRM-C-2P	<i>Folding Mounting Bracket w/ Leveler</i>
IKT-UVL32UL-AG	<i>UVC Bacterial Disinfection Kit</i>
IKT-SURPRK-DV2	<i>Ultimate Surge and Power Protection</i>