

Job Name:	
Submitted By:	



Submittal Sheet For:	<b>WT024GLSI20HLF / YN024GLSI20RPF</b>
----------------------	--

Date \_\_\_\_\_

Ref. \_\_\_\_\_

## Wall-Mounted Ductless 20SEER Inverter Heat Pump

System Full Set Model: **WYT024GLSI20RL**

AHRI Reference Number: **217048745**

### Cooling Mode Performance

Rated Cooling	24,000 BTU/hr
Ambient Range	5°F ~ 122°F
SEER Rating	21 BTU/W·h
EER Rating	11 BTU/W·h

\* 100% Capacity @ Indoor DB 80°F/WB 67°F / m.w. 16' lineset

### Heating Mode Performance

Rated Heating	24,600 BTU/hr
Ambient Range	-4°F ~ 86°F
HSPF2 IV (V)	9.5 (8.2) BTU/W·h
COP	3.41 W/W

\* High Heat (47°F) = 24,600 BTU / Low Heat (17°F) = 15,600 BTU / COP (5°F) = 2.1



Wall-Mounted Indoor Unit



Outdoor Condensing Unit



16' Installation Kit (Pipe + Cable)



Handheld Remote Controller

### Electrical Information

Rated Input (W)	Cooling	Heating
	2,080	1,800
Rated Current (A)	9.4	8.2
Breaker Needed	25A (Double-Pole)	
Power Supply	208~230V, 1Ph, 60Hz	

### Piping and Refrigerant

Liquid Line (OD)	1/4"
Suction Line (OD)	1/2"
Refrigerant Precharge	R454b (16 ft.)
Max Length/Height Diff.	65 ft. / 50 ft.

This combination is AHRI/ETL/ISO certified.



### Interior Unit (Air Handler) Specifications

Type	Heat Pump
Sound Level (dBA)	52 (Turbo) / 50 (Hi) / 44 (Med) / 38 (Lo) / 36 (Mute)
Auto Air Circulation	2-Way Louver (Up-Down + Left-Right)
Dimensions (WDH)	46"-7/8 x 10"-1/4 x 14"-1/4
Weight (lbs)	36.4

### Exterior Unit (Condenser) Specifications

Sound Level (dBA)	58
Recommended Room Size	750~1,000 Sq. ft.
Minimum Room Size	51 Sq. ft.
Compressor	Inverter-Driven Rotary
Dimensions (WDH)	36"-1/2 x 14"-7/8 x 27"-1/2
Weight (lbs)	88.2

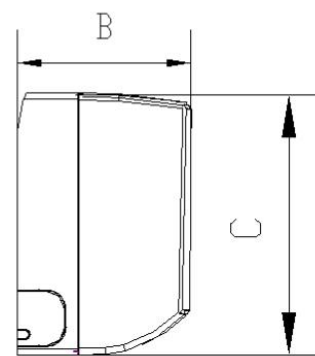
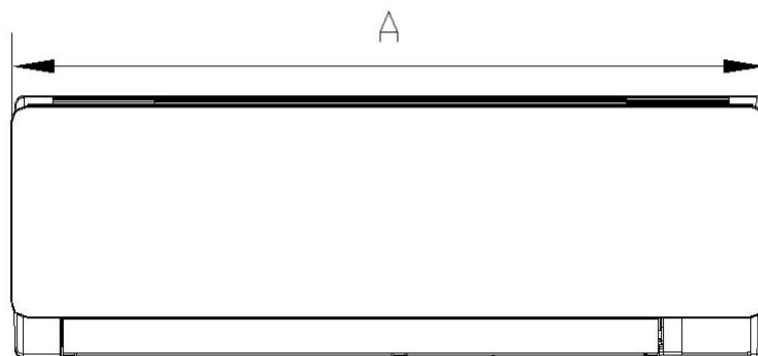
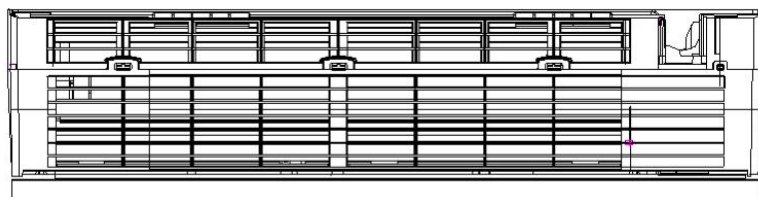

Model	A	B	C
WT024GLSI20HLF	1186 mm 46-3/4"	340 mm 13-3/8"	268 mm 10-5/8"

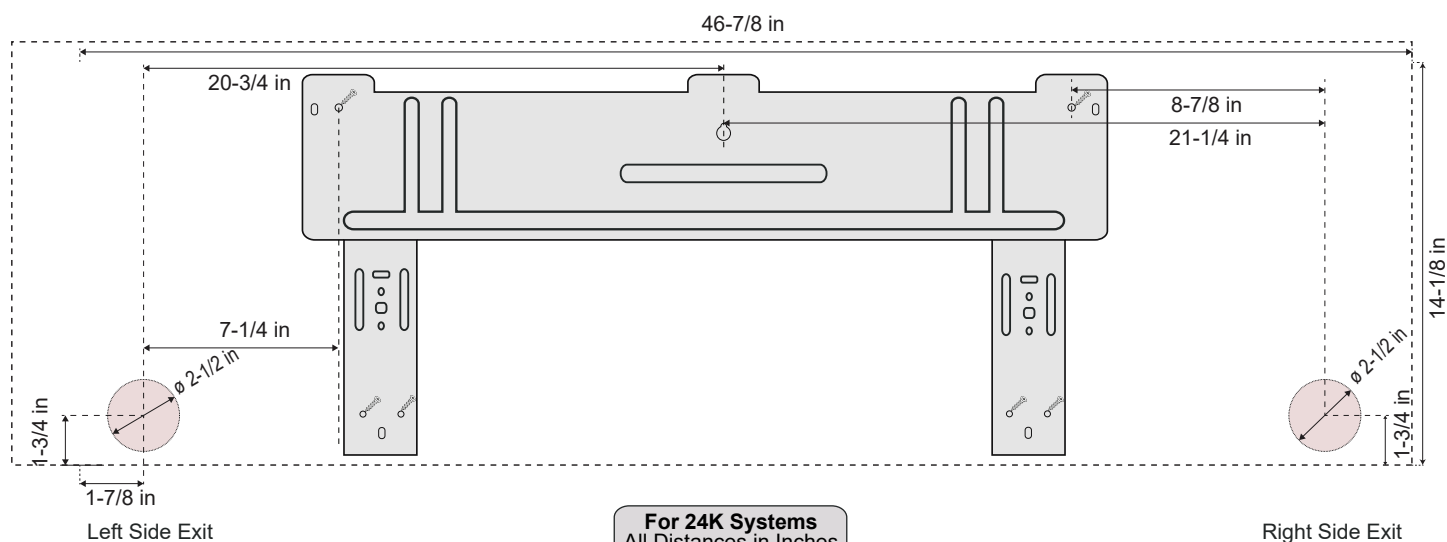

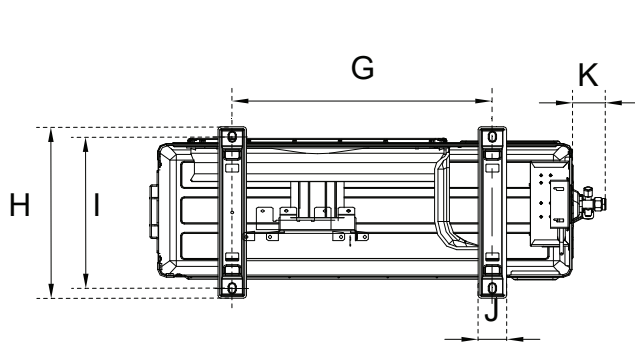
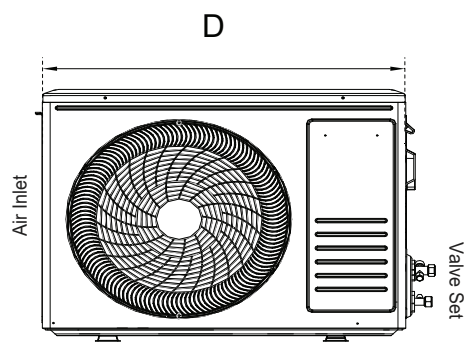
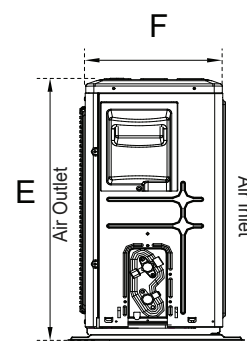
**Underside View**

**Front View**

**Side View**

Model	D	E	F	G	H	I	J	K
YN024GLSI20RPF	845 mm	699 mm	326 mm	586 mm	375 mm	348 mm	55 mm	55.9 mm
	33-1/4"	27-1/2"	12-7/8"	23-1/8"	14-3/4"	13-3/4"	2-1/8"	2-1/4"

## Warranty Information and Length



Complete warranty details are available with the vendor or online at <https://www.pdhvac.com/support/warranty/>. This high-quality system is eligible for up to a 5-year limited warranty on the compressor, and 5 years on other internal parts. To qualify for this warranty, the system must be installed within 90 days and registered properly. All other installations that are unregistered qualify for only 1-year parts/compressor warranty.

## Outstanding Features

- LED Display
- Energy Saving
- Ultra-Thin Design
- Dual Drain Options
- Customizable Timer
- Eco-Friendly Refrigerant
- Whisper-Quiet Operation
- Power Loss Memory Recovery

## Available Accessories

Part Number	Description
IKT-LCVR4P-KIT	<i>Decorative PVC Line Cover Kit</i>
IKT-LNBR-1/4-3/8	<i>BendAid Flexible Easy Bender Kit</i>
BRK-FRM-C-2P	<i>Folding Mounting Bracket w/ Leveler</i>
IKT-UVL32UL-AG	<i>UVC Bacterial Disinfection Kit</i>
IKT-SURPRK-DV2	<i>Ultimate Surge and Power Protection</i>