

Job Name:	
Submitted By:	



Submittal Sheet For:	WT036GLSI20HLF / YN036GLSI20RPF
----------------------	--

Date _____

Ref. _____

Wall-Mounted Ductless 20SEER Inverter Heat Pump

System Full Set Model: **WYT036GLSI20RL**

AHRI Reference Number: **217048747**

Cooling Mode Performance

Rated Cooling	36,000 BTU/hr
Ambient Range	5°F ~ 122°F
SEER Rating	19 BTU/W·h
EER Rating	9 BTU/W·h

* 100% Capacity @ Indoor DB 80°F/WB 67°F / m.w. 16" lineset

Heating Mode Performance

Rated Heating	36,000 BTU/hr
Ambient Range	-4°F ~ 86°F
HSPF2 IV (V)	9 (7.7) BTU/W·h
COP	3.15 W/W

* High Heat (47°F) = 36,000 BTU / Low Heat (17°F) = 21,800 BTU / COP (5°F) = 2.1



Wall-Mounted Indoor Unit



Outdoor Condensing Unit



16' Installation Kit (Pipe + Cable)



Handheld Remote Controller

Electrical Information

Rated Input (W)	Cooling	Heating
	3,850	3,350
Rated Current (A)	17.4	15.2
Breaker Needed	30A (Double-Pole)	
Power Supply	208~230V, 1Ph, 60Hz	

Piping and Refrigerant

Liquid Line (OD)	1/4"
Suction Line (OD)	5/8"
Refrigerant Precharge	R454b (16 ft.)
Max Length/Height Diff.	100 ft. / 65 ft.

This combination is AHRI/ETL/ISO certified.



Interior Unit (Air Handler) Specifications

Type	Heat Pump
Sound Level (dBA)	52 (Turbo) / 49 (Hi) / 43 (Med) / 38 (Lo) / 36 (Mute)
Auto Air Circulation	2-Way Louver (Up-Down + Left-Right)
Dimensions (WDH)	46"-7/8 x 10"-1/4 x 14"-1/4
Weight (lbs)	39.7

Exterior Unit (Condenser) Specifications

Sound Level (dBA)	63
Recommended Room Size	1,100~1,400 Sq. ft.
Minimum Room Size	63 Sq. ft.
Compressor	Inverter-Driven Rotary
Dimensions (WDH)	38"-1/2 x 16"-1/2 x 31"-5/8
Weight (lbs)	105.8

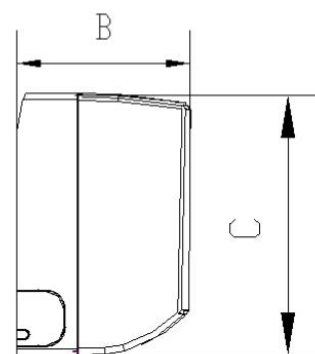
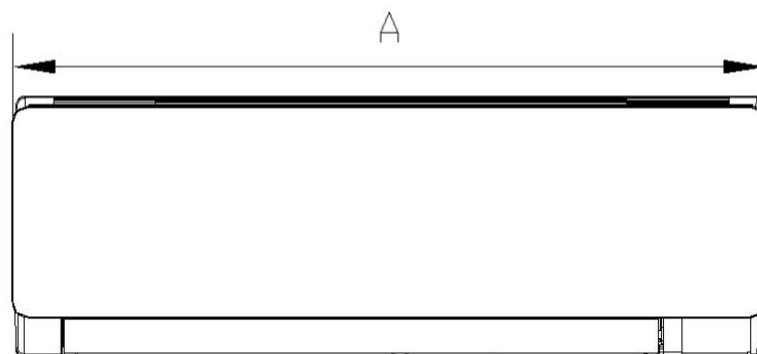
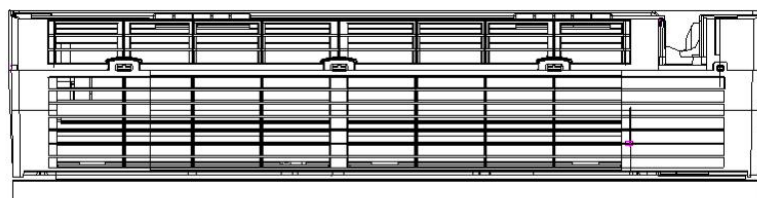

Model	A	B	C
WT036GLSI20HLF	1186 mm	340 mm	268 mm
	46-3/4"	13-3/8"	10-5/8"

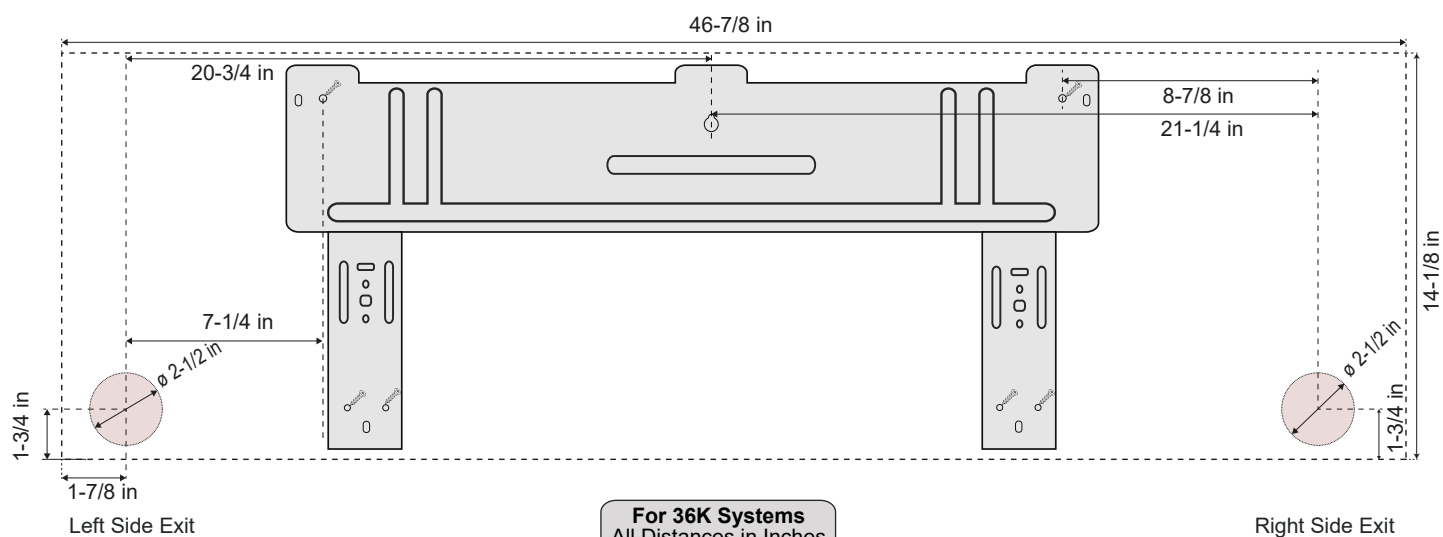

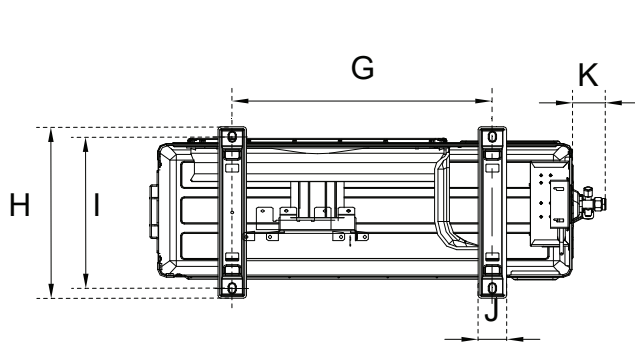

Underside View

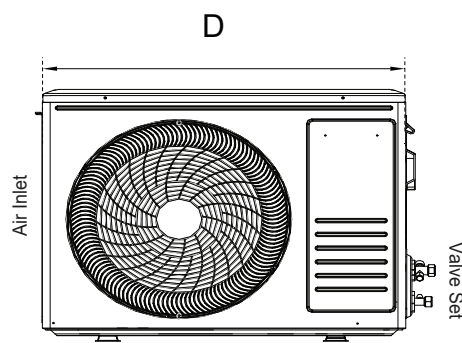

Front View

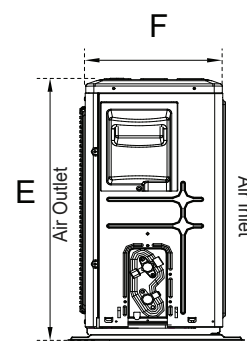

Side View

Model	D	E	F	G	H	I	J	K
YN036GLSI20RPF	910 mm	803 mm	359 mm	607 mm	421 mm	390 mm	60 mm	63 mm
	35-7/8"	31-5/8"	14-1/8"	23-7/8"	16-5/8"	15-3/8"	2-3/8"	2-1/2"

Warranty Information and Length



Complete warranty details are available with the vendor or online at <https://www.pdhvac.com/support/warranty/>. This high-quality system is eligible for up to a 5-year limited warranty on the compressor, and 5 years on other internal parts. To qualify for this warranty, the system must be installed within 90 days and registered properly. All other installations that are unregistered qualify for only 1-year parts/compressor warranty.

Outstanding Features

- LED Display
- Energy Saving
- Ultra-Thin Design
- Dual Drain Options
- Customizable Timer
- Eco-Friendly Refrigerant
- Whisper-Quiet Operation
- Power Loss Memory Recovery

Available Accessories

Part Number	Description
IKT-LCVR4P-KIT	<i>Decorative PVC Line Cover Kit</i>
IKT-LNBR-1/4-3/8	<i>BendAid Flexible Easy Bender Kit</i>
BRK-FRM-C-2P	<i>Folding Mounting Bracket w/ Leveler</i>
IKT-UVL32UL-AG	<i>UVC Bacterial Disinfection Kit</i>
IKT-SURPRK-DV2	<i>Ultimate Surge and Power Protection</i>