

Job Name:	
Submitted By:	



Submittal Sheet For:	WT018GLSI25HLH / YN018GLSI25RPH
----------------------	--

Date _____

Ref. _____

Wall-Mounted Ductless 25SEER Inverter Heat Pump

System Full Set Model: **WYT018GLSI25RH**

AHRI Reference Number: **217048756**

Cooling Mode Performance

Rated Cooling	18,000 BTU/hr
Ambient Range	5°F ~ 131°F
SEER Rating	23.5 BTU/W·h
EER Rating	12.5 BTU/W·h

* 100% Capacity @ Indoor DB 80°F/WB 67°F

Heating Mode Performance

Rated Heating	18,000 BTU/hr
Ambient Range	-22°F ~ 86°F
HSPF2 IV (V)	10.0 (9.0) BTU/W·h
COP	3.8 (W/W)

*High Heat (47°F) = 18,000 BTU / Low Heat (17°F) = 11,500 BTU / COP (5°F) = 1.8



Wall-Mounted Indoor Unit



Outdoor Condensing Unit



Installation Kit (Pipe + Cable)



Handheld Remote Controller

Electrical Information

	Cooling	Heating
Rated Input (W)	1,390	1,360
Rated Current (A)	6.2	6.1
Breaker Needed	30A (Double-Pole)	
Power Supply	208~230V, 1Ph, 60Hz	

Piping and Refrigerant

Liquid Line (OD)	1/4"
Suction Line (OD)	1/2"
Refrigerant Precharge	R454b (Selectable Lineset)
Max Length/Height Diff.	65 ft. / 50 ft.

This combination is
Energy-Star certified.



Interior Unit (Air Handler) Specifications

Type	Heat Pump
Sound Level (dBA)	48 (Turbo) / 45 (Hi) / 40 (Med) / 37 (Lo) / 34 (Mute)
Auto Air Circulation	2-Way Louver (Up-Down + Left-Right)
Dimensions (WDH)	43"-1/8 x 8"-3/4 x 13"
Weight (lbs)	30.9

Exterior Unit (Condenser) Specifications

Sound Level (dBA)	58
Recommended Room Size	500~750 Sq. ft.
Minimum Room Size	52 Sq. ft.
Compressor	Inverter-Driven Rotary
Dimensions (WDH)	36"-1/2 x 15" x 27"-1/2
Weight (lbs)	93.7

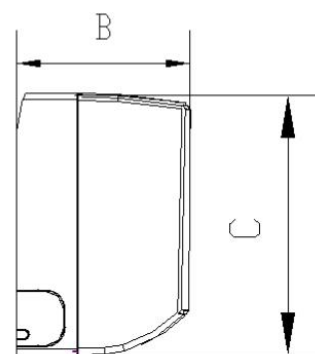
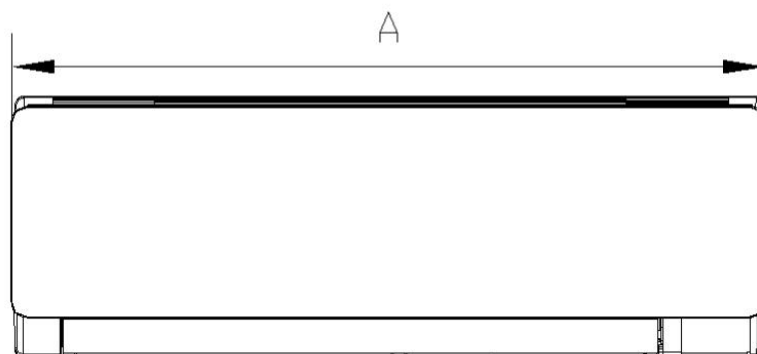
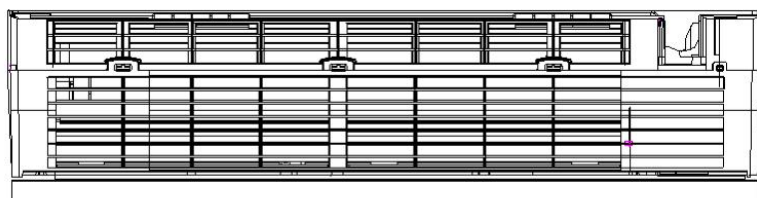

Model	A	B	C
WT018GLSI25HLH	1096 mm	222.3 mm	330.2 mm
	43-1/8"	8-3/4"	13"

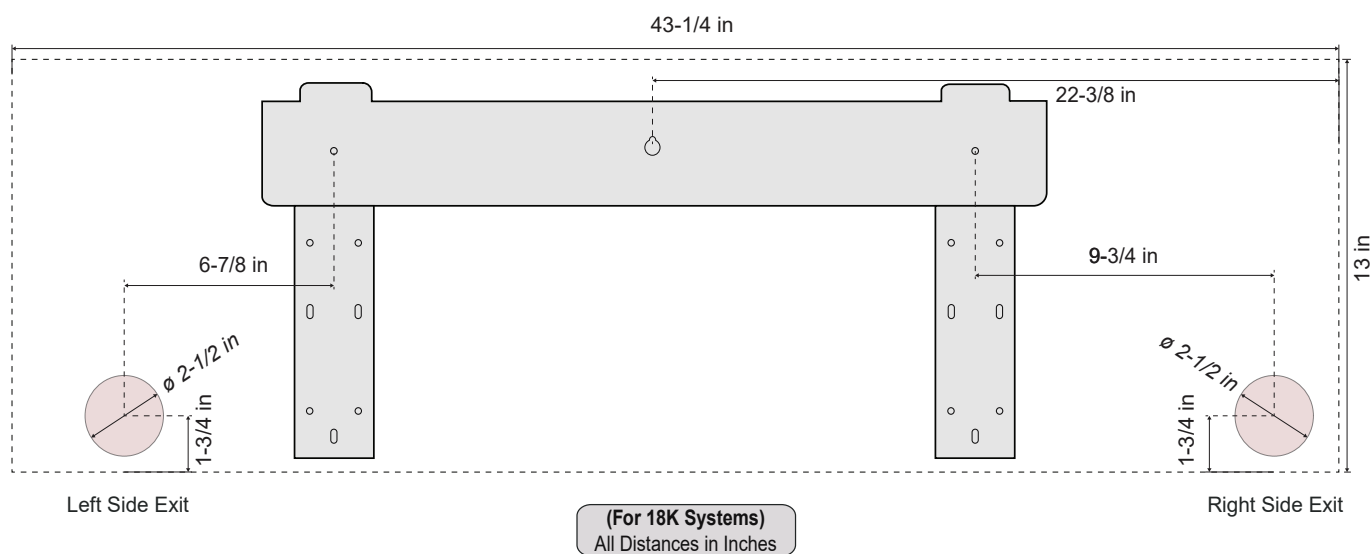

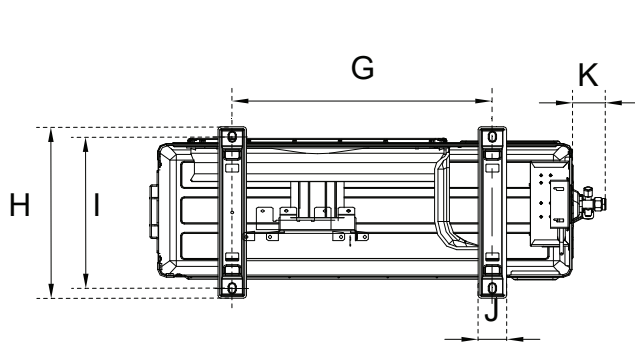

Underside View

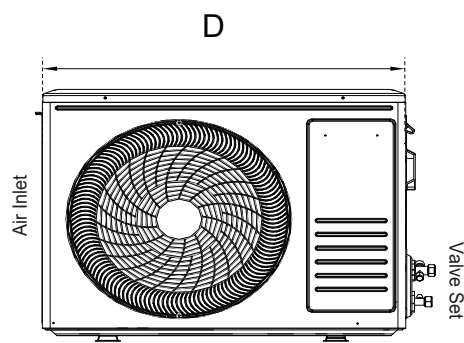

Front View

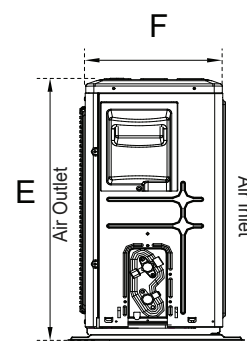

Side View

Model	D	E	F	G	H	I	J	K
YN018GLSI25RPH	847 mm	699 mm	326 mm	586 mm	375 mm	347 mm	59 mm	48 mm
	33-3/8"	27-1/2"	12-7/8"	23-1/8"	14-3/4"	13-5/8"	2-3/8"	1-7/8"

Warranty Information and Length



Complete warranty details are available with the vendor or online at <https://www.pdhvac.com/support/warranty/>. This high-quality system is eligible for up to a 5-year limited warranty on the compressor, and 5 years on other internal parts. To qualify for this warranty, the system must be installed within 90 days and registered properly. All other installations that are unregistered qualify for only 1-year parts/compressor warranty.

Outstanding Features

- LED Display
- Energy Saving
- Ultra-Thin Design
- Dual Drain Options
- Customizable Timer
- Eco-Friendly Refrigerant
- Whisper-Quiet Operation
- Power Loss Memory Recovery

Available Accessories

Part Number	Description
IKT-LCVR4P-KIT	<i>Decorative PVC Line Cover Kit</i>
IKT-LNBR-1/4-3/8	<i>BendAid Flexible Easy Bender Kit</i>
BRK-FRM-C-2P	<i>Folding Mounting Bracket w/ Leveler</i>
IKT-UVL32UL-AG	<i>UVC Bacterial Disinfection Kit</i>
IKT-SURPRK-DV2	<i>Ultimate Surge and Power Protection</i>