

The design and specifications of this product are subject to change without prior notice as development continues. Consult with the sales agency or manufacturer for details.



is a registered trademark of Parker Davis HVAC International, Inc.

Parker Davis HVAC International, Inc.

2250 NW 102 Place, Doral, FL 33172 - USA

Tel. : (305) 513-4488

Fax : (305) 513-4499

e-mail : info@pd-hvac.com

Website: www.pd-hvac.com

CR166-RG57A6EU-6

Copyright 2016, Parker Davis HVAC International, Inc., All rights reserved.



INFRARED WIRELESS MULTI-FUNCTION REMOTE CONTROLLER

OWNER'S MANUAL

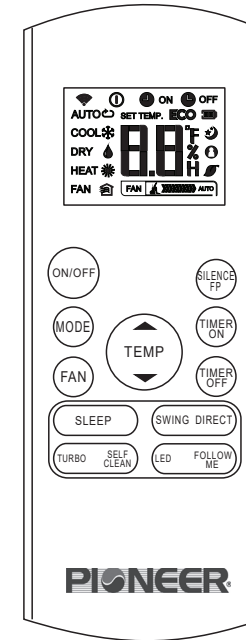

Read and understand this manual thoroughly before operating your new air conditioning unit. Be sure to store this manual for future reference.

CONTENTS

Remote Controller Layout.....	2
Operational Buttons.....	3
LCD Screen Indicators.....	6
How to Use the Buttons.....	7
Auto Operation.....	7
Cooling/Heating/Fan Operation.....	7
Dehumidifying Operation.....	8
Timer Operation.....	9
Handling the Remote Controller.....	12

NOTICE:

- The layout of the functional buttons on this remote as depicted here is for the standard model. Actual model purchased may vary slightly from this illustration.
- The signal output sent by this remote controller is processed entirely by the receiving air conditioning system. In case any of the functions of the remote are not available for the specific model of the air conditioner, those functions will not work.
- Your product user's manual may have additional information regarding the proper usage of this remote controller.

Remote Controller Layout and Specifications

Model	RG57A6/BGEFU1
Rated Voltage	3.0V (Dry batteries R03/LR03x2) (2 x AAA)
Signal Receiving Range	8m (25 Feet)
Environment	23°F~140°F

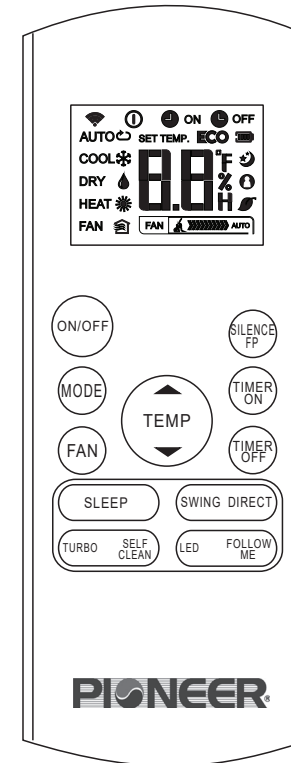

Operational Buttons

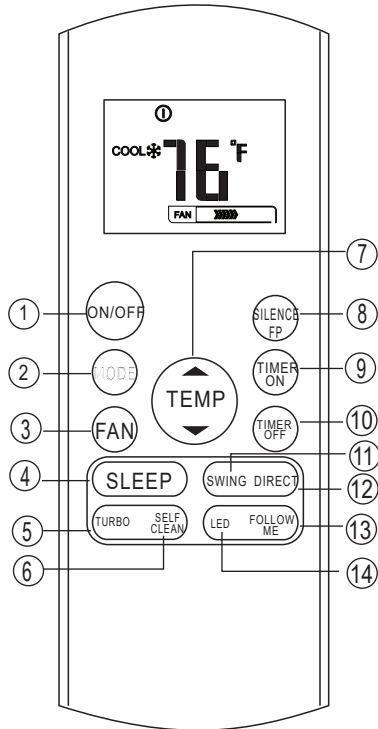

Note on DUAL-FUNCTION Buttons:

- TURBO/SELF-CLEAN, SWING-DIRECT and LED-FOLLOW-ME buttons are dual-function buttons. The LEFT and RIGHT edges of these buttons activate the separate specific functions printed nearest to that edge.
- The SILENCE/FP button is also a dual-function button that activates various separate functions based on the length of time pressed, which is further explained in the following pages.

- 1 **ON/OFF (Power) Button**
Pressing this button once turns the power to the system ON or OFF.
- 2 **MODE (Operation Mode) Button**
Pressing this button will cycle the unit's operating modes in the following sequence.
→ AUTO → COOL → DRY → HEAT → FAN

Note: Cooling-only versions of any system will not respond to selection of HEAT mode.

- 3 **FAN SPEED (Selector) Button**
Pressing this button will cycle the speed of the indoor unit's fan (air flow volume) in the following sequence.
→ AUTO → LOW → MED → HIGH
- Note: Fan speed cannot be controlled by the remote while running AUTO or DRY modes.

- 4 **TURBO (Performance) Button**
Pressing this button activates the high performance function, so that the system can establish the desired temperature level within the shortest amount of time, in both COOL and HEAT modes.
(If the air conditioner is not equipped with this function, it will not respond.)

- 5 **SELF-CLEAN Button**
Pressing this button will activate a fan-only mode to dry the internal components before long-term downtime. This mode can only be activated under COOL or DRY modes, and lasts 16 minutes before the system turns off.

- 6 **SLEEP Button**
Activates Sleep Mode, corresponding to the natural human sleep cycle, by lowering or raising the set temperature in 2 steps. When activated, this mode changes the set temperature by 2°F for each of the first and second hours of the sleep cycle and turns the system off when a total period of 8 hours has elapsed. Available in COOL, HEAT, and AUTO Modes. Press either the MODE, FAN, or POWER buttons to cancel.

3

Operational Buttons

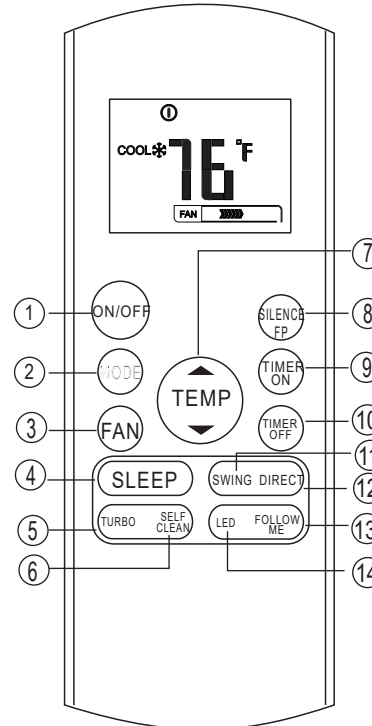

- 7 **UP Temperature Button (▲)**
Each time this button is pressed, the set temperature will increase in 1°F increments, up to a maximum of 86°F.
 - 8 **DOWN Temperature Button (▼)**
Pressing this button will decrease the set temperature in 1°F increments, down to a minimum of 62°F.
- Notes:**
- Temperature controls are not available while running FAN mode.
 - Pressing and holding the UP and DOWN buttons simultaneously will change the display temperature between C and F degrees.

- 8 **SILENCE (Quiet Mode) and FP (Low Heat) Dual-Function Button**

- Pressing this button briefly will set the compressor and the indoor fan motor to run at their lowest allowable speed settings for extra-quiet operation. However, when running this mode, the cooling and heating capacity may not be satisfactory if the zone heating or cooling loads are higher than this lowered capacity that the system operates at.

- Pressing and holding this button for 2 seconds will activate LOW-HEAT (or Vacation) Mode: useful for preventing frost when the room will be unoccupied during winter. This mode can only be activated when system is in HEAT mode. LOW-HEAT mode will set the temperature down to 46°F and run low heat cycle to save energy. Deactivate by pressing POWER, FAN, FP, TEMP, or MODE buttons.

- 9 **TIMER ON Button**
Pressing this button will advance the set time for automatic system start by 30 min. for each press, reaching up to 10.0, and 60 min. each press thereafter.

When the total set time elapses, the system will start automatically. To cancel the set ON time, keep pressing the TIMER ON button until the display shows 0.0.

SLEEP Mode Details:
Human body temperature drops during sleep. To match this change in body temperature:

- If the Sleep Mode is activated while running COOL mode, the system will increase the set temperature by 2°F within 60 minutes, and by an additional 2°F within the next 60 minutes.
- If the Sleep Mode is activated while running HEAT mode, the system will reduce the set temperature by 2°F within 60 minutes, and by an additional 2°F within the next 60 minutes.
- System turns off 8 hours after sleep mode is activated. Use the Timer ON Function to start the system automatically after sleep mode.

4

Operational Buttons

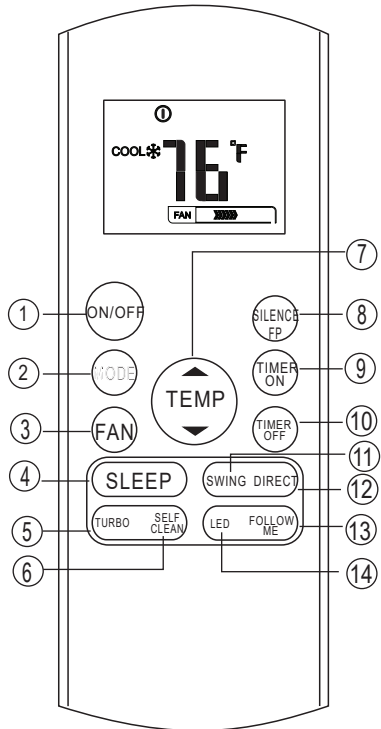

Further note on LED button use:

To connect a Wi-Fi Remote access module to this system, AP Mode must be activated.

- The LED button is used to activate AP mode, to be able to connect this unit with the optional Wi-Fi module.
- Press the LED side (left side) of this button 7 or more times within 3 minutes and the front panel display of the unit will display AP.
- Follow the detailed instructions supplied with the Wi-Fi module for further pairing and other programming details.

- 10 **TIMER OFF Button**
Pressing this button will advance the set time for automatic system stop by 30 min. each press, reaching up to 10.0, and 60 min. each press thereafter.

When the total set time elapses, the system will stop automatically.
To cancel the set OFF time, keep pressing the TIMER OFF button until the display shows 0.0.

SWING/DIRECT Dual-Function Button

- 11 **SWING:** PRESS AT LEFT EDGE:
Press to start and stop the horizontal louver's Automatic Air-Sweep Function.
- 12 **DIRECTION:** PRESS AT RIGHT EDGE:
Press to change the angle of the horizontal louver UP or DOWN in 6 degree intervals.

LED/FOLLOW-ME Dual Function Button

- 13 **FOLLOW ME:** PRESS AT RIGHT EDGE:
Press to activate the internal temperature sensor in the remote controller, instead of the one inside the air conditioner, to measure actual locational temperature where the remote controller is placed. This is especially useful for when the system is installed in an area with temperature differences from the actual living space. Once activated, the LCD screen will show the measured temperature at the location of the remote controller, and will upload this measurement to the system once every 3 minutes for processing. Mode is automatically canceled if the system does not receive data for 7 minutes.
- 14 **LED:** PRESS AT LEFT EDGE:
Pressing this button will dim the LED display on the front panel for nocturnal comfort. Pressing it again will turn the display brightness back on.

Indicators on LCD

LCD screen on the remote controller will display a variety of information when it is ON, as indicated below.

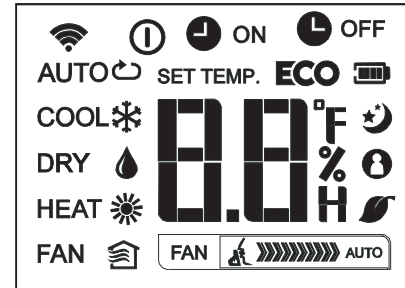

Mode Display

AUTO COOL DRY
HEAT FAN

- Icon displayed when info is transmitted.
- Icon displayed when the remote is ON.
- Icon displayed when the batteries are low.
- Icon displayed when the ECO mode is ON.
- ON Displayed when TIMER ON time is set.
- OFF Displayed when TIMER OFF time is set.
- 2-digit temperature display indicating the set temperature or room temperature. Also displays TIME when setting the TIMER ON and/or TIMER OFF.
- Displayed when the SLEEP function is activated.
- Displayed when the FOLLOW ME function is activated.
- Not applicable to this version.
- Displayed when the SILENCE function is activated.

Fan Speed Indication

- FAN [>>>] Low speed
- FAN [>>>>>] Medium speed
- FAN [>>>>>>>] High speed
- FAN [] AUTO Auto fan speed

Note:

All indicator icons shown in the figure above may not be available based on the conditions of the actual operation or the system settings.

How to Use the Buttons

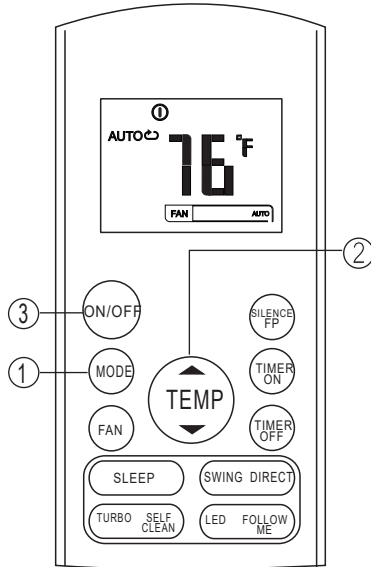

Auto Operation

Ensure that the system is powered. The OPERATION indicator on the LED display of the indoor unit will start flashing.

1. Press the **MODE** button to select Auto.
2. Press the **UP/DOWN** button to set the desired temperature. The temperature can be set within a range of 62°F-86°F, in 1°F increments.
3. Press the **ON/OFF** button to start the air conditioner.

NOTE:

1. In Auto Mode, the air conditioner can logically choose Cooling, Fan, and Heating modes by sensing the difference between the actual ambient room temperature and the setting temperature on the remote controller.
2. For Auto Mode, fan speed cannot be selected. Fan speed is automatically controlled in Auto Mode.
3. If Auto Mode does not provide desired comfort levels, other suitable modes should be selected.

Cooling /Heating/Fan Operation

Ensure that the system is powered. The OPERATION indicator on LED display of the indoor unit will start flashing.

1. Press the **MODE** button to select COOL, HEAT(cooling & heating models only), or FAN mode.
2. Press the **UP/DOWN** buttons to set the desired temperature. The temperature can be set within a range of 62°F-86°F, in 1°F increments.
3. Press the **FAN** button to select the fan speed in four steps: Auto, Low, Med, or High.
4. Press the **ON/OFF** button to start the air conditioner.

NOTE

When using FAN mode, the temperature setting will not be displayed on the remote and the room temperature settings will be inaccessible. Therefore, only steps 1, 2, and 4 above can be performed.

7

How to Use the Buttons

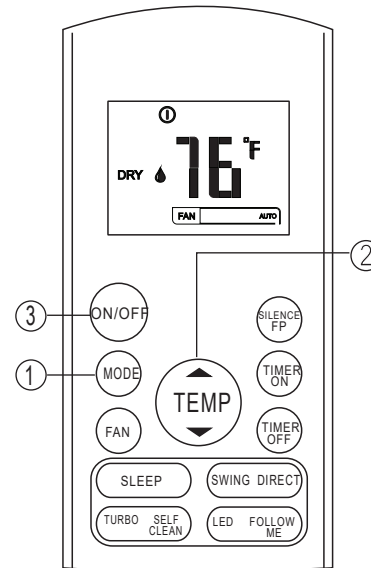

Dehumidifying Operation

Ensure that the system is powered. The OPERATION indicator on the LED display of the indoor unit will start flashing.

1. Press the **MODE** button to select DRY mode.
2. Press the **UP/DOWN** buttons to set the desired temperature. The temperature can be set within a range of 62°F-86°F, in 1°F increments.
3. Press the **ON/OFF** button to start the air conditioner.

NOTE

For the DEHUMIDIFICATION mode, fan speed cannot be selected. Fan speed is automatically controlled in Dehumidification Mode.

8

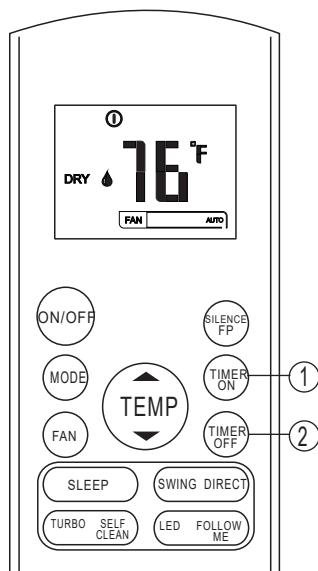

Timer Operation

By pressing the TIMER ON button, the automatic starting time can be set up. By pressing the TIMER OFF button, the automatic stopping time can be setup.

To set the Auto-On time.

1. Press the TIMER ON button. The remote controller shows TIMER ON, the last Auto-On setting time, and the signal "H" will be shown on the LCD display area. Now it is ready to reset the Auto-On time to START the operation.
2. Push the TIMER ON button again to set desired Auto-On time. Each time you press the button, the time increases by half an hour, between 0 and 10 hours, and by one hour between 10 and 24 hours.
3. After setting the TIMER ON, there will be a one second delay before the remote controller transmits the signal to the air conditioner. Then, after approximately another 2 seconds, the signal "H" will disappear, and the set temperature will re-appear on the LCD display window.

To set the Auto-Off Time.

1. Press the TIMER OFF button. The remote controller shows TIMER OFF, the last Auto-Off setting time, and the signal "H" will be shown on the LCD display area. Now it is ready to reset the Auto-Off time to stop the operation.
2. Push the TIMER OFF button again to set desired Auto-Off time. Each time you press the button, the time increases by half an hour between 0 and 10 hours, and by one hour between 10 and 24 hours.
3. After setting the TIMER OFF, there will be a one second delay before the remote controller transmits the signal to the air conditioner. Then, after approximately another 2 seconds, the signal "H" will disappear, and the set temperature will re-appear on the LCD display window.

CAUTION

- When you select the timer operation, the remote controller automatically transmits the timer signal to the indoor unit for the specified time. Therefore, keep the remote controller in a location where it can transmit the signal to the indoor unit properly.
- The effective operation time set by the remote controller for the timer function is limited to the following settings: 0.5, 1.0, 1.5, 2.0, 2.5, 3.0, 3.5, 4.0, 4.5, 5.0, 5.5, 6.0, 6.5, 7.0, 7.5, 8.0, 8.5, 9.0, 9.5, 10, 11, 12, 13, 14, 15, 16, 17, 18, 19, 20, 21, 22, 23 and 24. (Hours of time elapsed from the transmission of the setting).

Example of Timer Setting

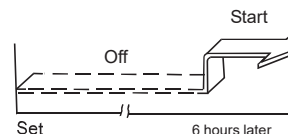

TIMER ON (Auto-On Operation)

The TIMER ON feature is useful when you want the unit to turn on automatically before you return home. The air conditioner will automatically start operating at the set time.

Example:

To start the air conditioner in 6 hours.

1. Press the TIMER ON button. The last setting of starting operation time and the signal "H" will show on the display area.
2. Press the TIMER ON button to display "6.0H" on the TIMER ON display of the remote controller.
3. Wait for 3 seconds and the digital display area will show the temperature again. The "TIMER ON" indicator remains on and this function is activated.

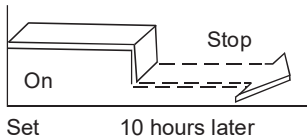

TIMER OFF (Auto-Off Operation)

The TIMER OFF feature is useful when you want the unit to turn off automatically after you go to bed. The air conditioner will stop automatically at the set time.

Example:

To stop the air conditioner in 10 hours.

1. Press the TIMER OFF button. The last setting of stopping operation time and the signal "H" will show on the display area.
2. Press the TIMER OFF button to display "10H" on the TIMER OFF display of the remote controller.
3. Wait for 3 seconds and the digital display area will show the temperature again. The "TIMER OFF" indicator remains on and this function is activated.

COMBINED TIMER

(Setting both ON and OFF timers simultaneously)

TIMER OFF / TIMER ON (On > Stop > Start operation)

This feature is useful when you want to stop the air conditioner after you go to bed, and start it again in the morning when you wake up or when you return home.

Example:

To stop the air conditioner 2 hours after setting, and start it again 10 hours after setting.

1. Press the TIMER OFF button.
2. Press the TIMER OFF button again to display 2.0H on the TIMER OFF display.
3. Press the TIMER ON button.
4. Press the TIMER ON button again to display 10H on the TIMER ON display.
5. Wait for 3 seconds and the digital display area will show the temperature again. The "TIMER ON OFF" indicator remains on and this function is activated.

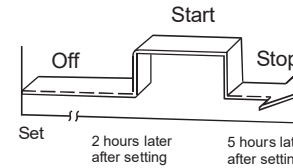

TIMER ON / TIMER OFF (Off > Start > Stop operation)

This feature is useful when you want to start the air conditioner before you wake up and stop it after you leave the house.

Example:

To start the air conditioner 2 hours after setting, and stop it 5 hours after setting.

1. Press the TIMER ON button.
2. Press the TIMER ON button again to display 2.0H on the TIMER ON display.
3. Press the TIMER OFF button.
4. Press the TIMER OFF button again to display 5.0H on the TIMER OFF display.
5. Wait for 3 seconds and the digital display area will show the temperature again. The "TIMER ON & TIMER OFF" indicators remain on and both functions are activated.

Handling the Remote Controller

Location of the Remote Controller.

- Use the remote controller within a distance of 8 meters (25') from the unit, pointing it towards the receiver. Reception is confirmed by a beep.

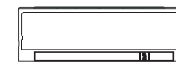

CAUTIONS

- The air conditioner will not operate if curtains, doors, or other materials block the signals from the remote controller to the indoor unit.
- Prevent any liquid from falling into the remote controller. Do not expose the remote controller to direct sunlight or heat.
- If the infrared signal receiver on the indoor unit is exposed to direct sunlight, the air conditioner may not function properly. Use curtains to prevent sunlight from falling on the receiver.
- If other electrical appliances react to the remote controller, either move these appliances or consult your local dealer.
- Do not drop the remote controller. Handle with care.
- Do not place heavy objects on the remote controller, or step on it.

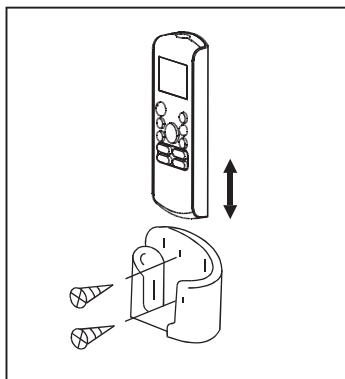

Using the Remote Controller Holder (Optional)

- The remote controller can be attached to a wall or column using a remote controller holder (not included, sold separately).
- Before installing the remote controller, check that the air conditioner receives signals properly.
- Install the remote controller with two screws.
- For placing or removing the remote controller, move it up or down in the holder.

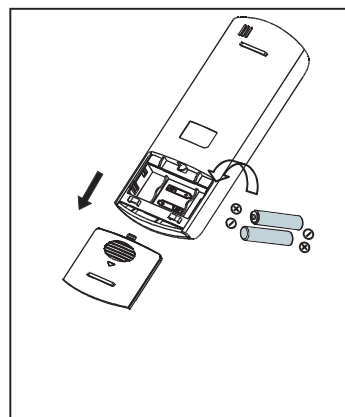

Replacing Batteries

The following cases signify exhausted batteries. Replace old batteries with new ones.

- Receiving beep is not emitted when a signal is transmitted.
- Indicator fades away.

The remote controller is powered by two dry batteries (R03/LR03X2) housed in the back rear part, and protected by a cover (AAA size).

- (1) Remove the cover in the rear part of the remote controller.
- (2) Remove the old batteries and insert the new batteries, placing the (+) and (-) ends correctly.
- (3) Install the cover back on.

NOTE: When the batteries are removed, the remote controller erases all programming. After inserting new batteries, the remote controller must be reprogrammed.

▲ CAUTIONS

- Do not mix old and new batteries, or batteries of different types.
- Do not leave the batteries in the remote controller if they are not going to be used for 2 or 3 months.
- Do not dispose batteries as unsorted municipal waste. Collection of such waste separately for special treatment is necessary.

Installer / Programming Functions:

This remote controller is capable of other complex functions for altering the programs built in your system as well as diagnostic tools for reading certain operational data.

- Changing any setting by using the programmer module, without training, can cause significant operational deficiencies.
- A specific manual outlining the details of this module can be obtained from the manufacturer for use by trained installers.
- Ask your installer or the technical support team if any specific changes to the system software is deemed necessary.

The same models of remote controllers use the same infrared signal frequencies. Therefore, if more than one system is located within the transmission direction of the signal from one remote, it is possible to command another system simultaneously. Use the remote controller nearest to the intended system to overcome this issue.

Remember, your system has an emergency start button under the front panel. Should your remote controller become defective, lost, or the batteries run out, you can press the emergency start button to temporarily use the air conditioner until a new remote controller or batteries can be obtained. See your USER MANUAL for the emergency start button location and usage.

Refer to the system's user manual for any additional information that may be covered.

Spare remote controllers can be easily obtained at very reasonable cost. Contact the agency from where you purchased your system.

NOTE:

This device complies with all local national regulations.

- In Canada, it complies with CAN ICES-3(B)/NMB-3(B).
- In USA, this device complies with part 15 of the FCC Rules. Operation is subject to the following two conditions:
 - (1) This device may not cause harmful interference, and
 - (2) This device must accept any interference received, including interference that may cause undesired operation.

This equipment has been tested and found to comply within the limits for a Class B digital device, pursuant to part 15 of the FCC Rules. These limits are designed to provide reasonable protection against harmful interference in a residential installation. This equipment generates, uses, and can radiate radio frequency energy and, if not installed and used in accordance with the instructions, may cause harmful interference to radio communications. However, there is no guarantee that interference will not occur in a particular installation. If this equipment does cause harmful interference to radio or television reception, which can be determined by turning the equipment off and on, the user is encouraged to try to correct the interference by one or more of the following measures:

- Reorient or relocate the receiving antenna.
- Increase the separation between the equipment and receiver.
- Connect the equipment into an outlet on a circuit different from that to which the receiver is connected.
- Consult the dealer or an experienced radio/TV technician for help.

Changes or modifications not approved by the party responsible for compliance could void user's authority to operate the equipment.