

| | |
|---------------|--|
| Job Name: | |
| Submitted By: | |



Submittal Sheet For: YN009ALFI22RPD / WT009ALFI22HLD

Date _____
 Ref. _____

Wall Mounted Inverter Driven Heat Pump (0.75 Ton)

System Full Set Model: **WYT009ALFI22RL**
 AHRI Reference Number: **207743766**

Cooling Mode Performance

| | |
|---------------|--------------|
| Rated Cooling | 9000 BTU/hr |
| Ambient Range | 5°F ~ 122°F |
| SEER Rating | 22.0 BTU/W·h |
| EER Rating | 12.5 BTU/W·h |

* 100% Capacity @ Indoor DB 80°F/WB 66°F / Outdoor DB 95°F/WB 75°F / m.w. 16"lineset

Heating Mode Performance

| | |
|---------------|--------------------|
| Rated Heating | 9500 BTU/hr |
| Ambient Range | -13°F ~ 86°F |
| HSPF IV (V) | 10.0 (8.0) BTU/W·h |
| COP | 3.5 W/W |

* High Heat (47°F) = 9500 BTU / Low Heat (17°F) = 5900 BTU / COP(5°F) = 1.75

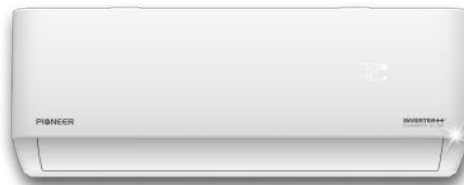

Wall-Mounted Indoor Unit



Outdoor Condensing Unit



16' Installation Kit (Pipe+Cable)



Handheld Remote Controller

Electrical Information

| Rated Input (W) | Cooling | Heating |
|-------------------|---------------------|---------|
| | 710 | 730 |
| Rated Current (A) | 6.4 | 6.5 |
| Breaker Needed | 20A (single-pole) | |
| Power Supply | 110/120V, 1Ph, 60Hz | |

Piping and Refrigerant

| | |
|-------------------------|---------------------|
| Liquid Line (OD) | 1/4" |
| Suction Line (OD) | 3/8" |
| Refrigerant Precharge | R410a (10 - 25 ft.) |
| Max Length/Height Diff. | 50 Ft. / 33 Ft. |

This combination is Energy-Star® certified.



Interior Unit (Air Handler) Specifications

| | |
|----------------------|--|
| Airflow Rate (cfm) | 382 (Hi) / 324 (Med) / 265 (Lo) |
| Sound Level (dBA) | 39 (Hi) / 34 (Med) / 29 (Lo) / 27 (Mute) |
| Auto Air Circulation | 2-Way Louver (Up-Down + Left-Right) |
| Dimensions (WDH) | 32"-1/4 x 7"-5/8 x 12" |
| Weight (Lbs) | 19.8 |

Exterior Unit (Condenser) Specifications

| | |
|--------------------|--------------------------|
| Airflow Rate (cfm) | 1,235 |
| Sound Level (dBA) | 50.0 |
| Metering Device | Capillary Tube |
| Compressor | Rotary |
| Dimensions (WDH) | 28"-5/8 x 12" x 21"-5/8" |
| Weight (Lbs) | 51.8 |

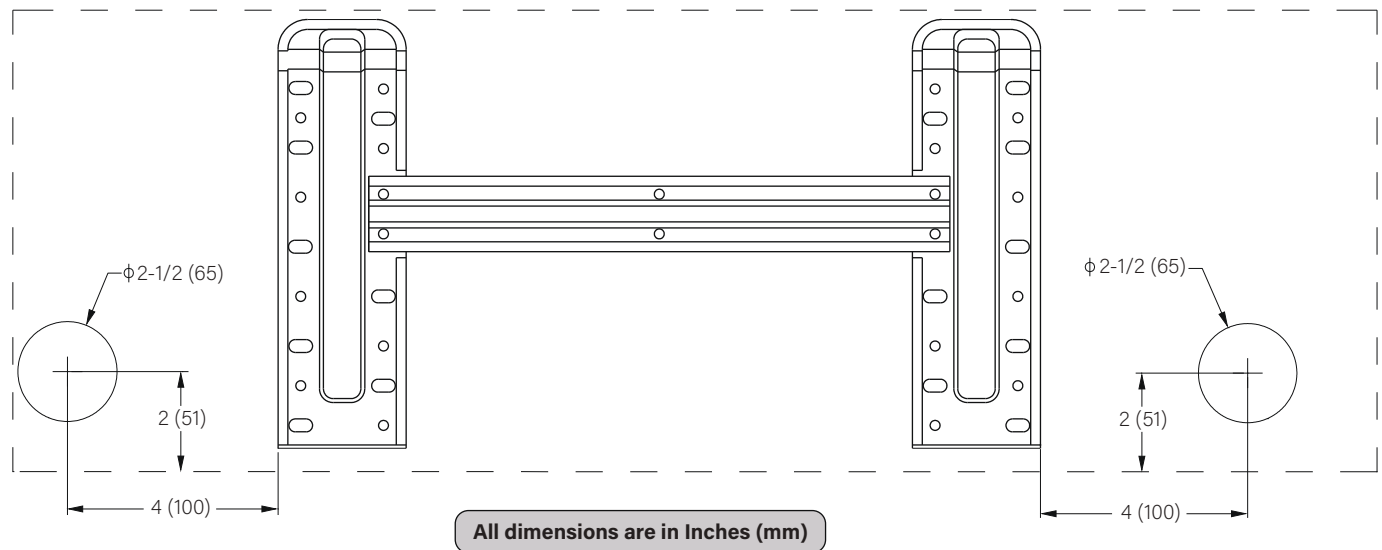
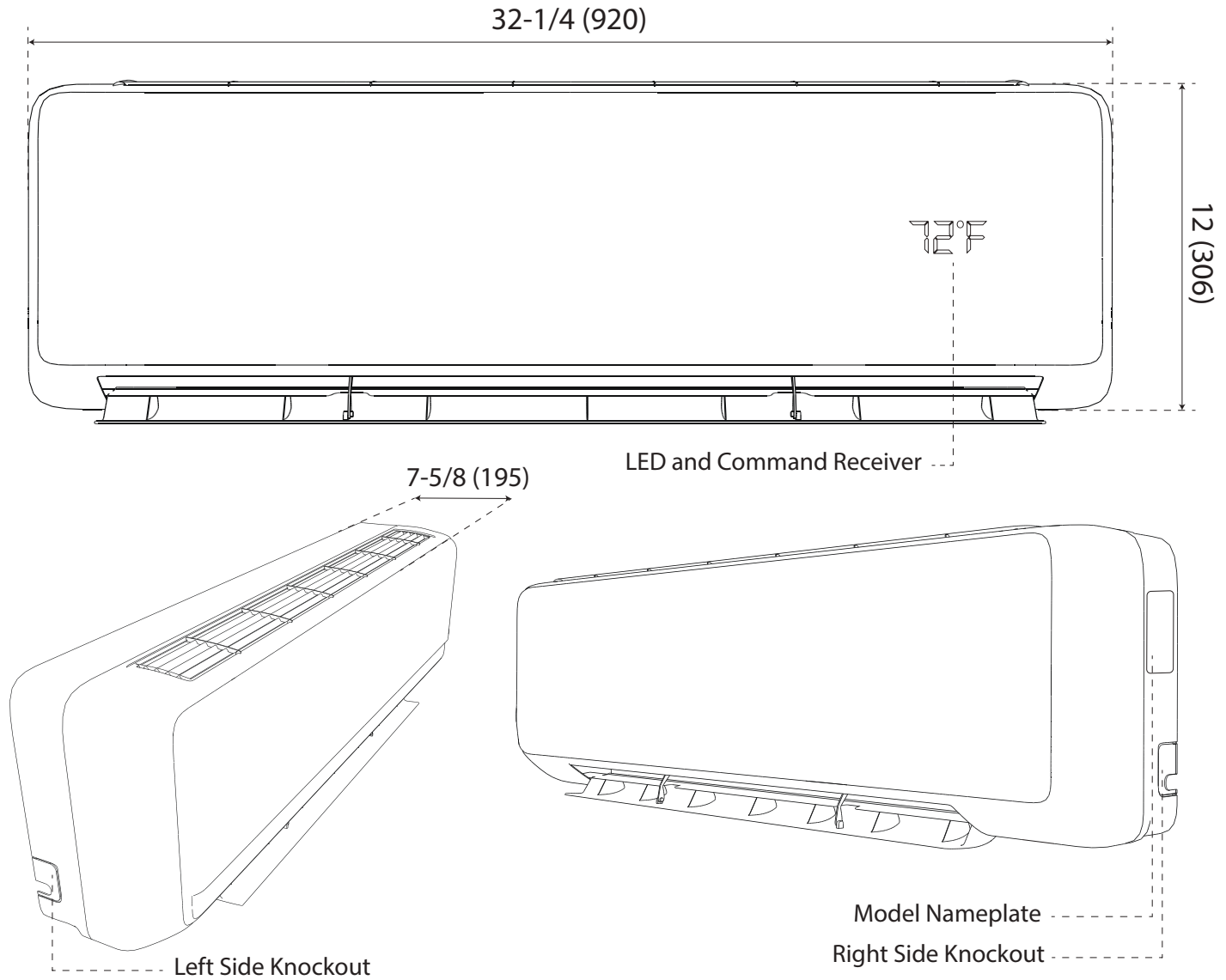

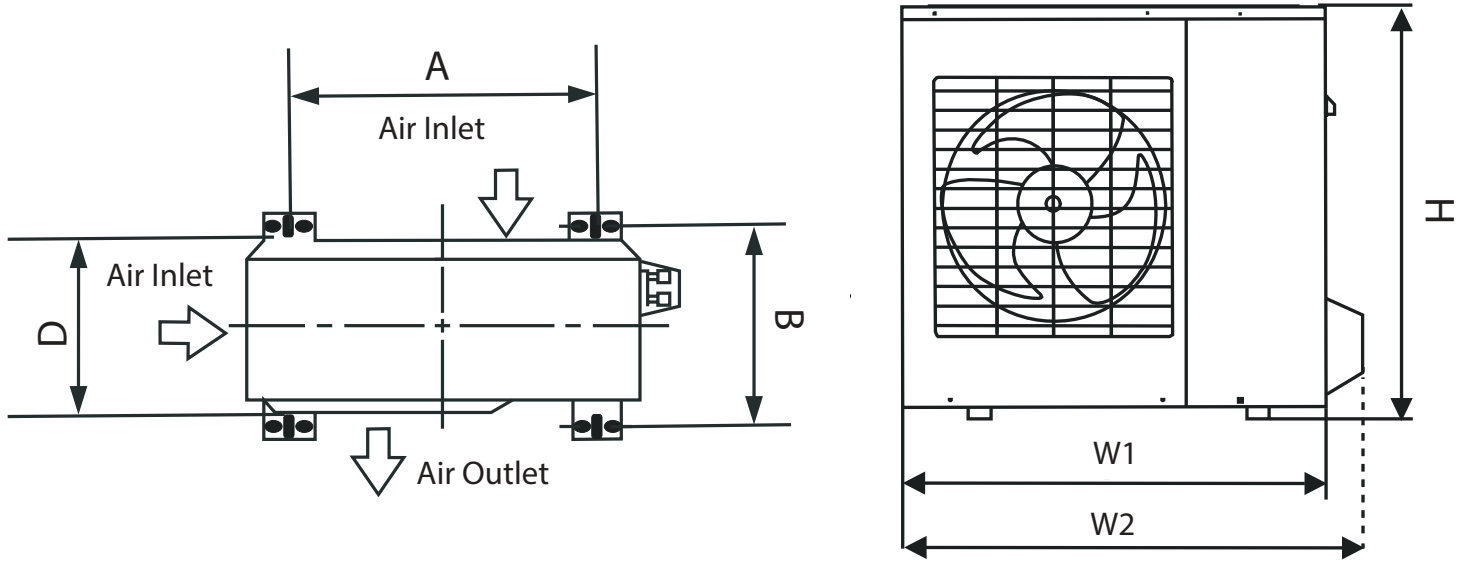

| Pioneer WYT Series Mini Split MODEL/Capacity (Btu/h) | A | B | D | H | W1 | W2 |
|---|----------------------|------------------------|------------------|----------------------|----------------------|----------------------|
| YN009ALFI22RPD (9,000 BTU - 110/120V) | 438 mm 17-1/4 in. | 278 mm 10-15/16 in. | 255 mm 10 in. | 546 mm 21-1/2 in. | 728 mm 28-5/8 in. | 810 mm 31-7/8 in. |

Warranty Information and Length



Complete warranty details are available with the vendor or online at <https://www.pdhvac.com/support/warranty/>. This high quality system is eligible for up to **10** years limited warranty on the compressor, and **7** years on other internal parts. To qualify for this warranty, the system must be installed within 90 days by a registered technician. All other installations that are registered default to **5** years parts/compressor. Products unregistered qualify for only **1** year parts/compressor warranty.

Outstanding Features

- Wi-Fi Enabled
- Auto Restart Function
- ECO Energy Saving Mode
- Vacation Mode (46°F setting)
- DRY Dehumidification Mode
- Dual Directional 3D Air Louver
- 24 hr. Timer & Weekly Scheduling
- I FEEL Remote Thermostat Setting



Available Accessories

| Part Number | Description |
|----------------|--|
| IKT-LCVR4P-KIT | <i>Decorative PVC Line Cover Kit</i> |
| CP-RE-MWP-06 | <i>Condensate Pump, Multi Voltage</i> |
| BRK-FRM-C-2P | <i>Folding Mounting Bracket w/ Leveler</i> |
| IKT-UVL32UL-AG | <i>UVC Bacterial Disinfection Kit</i> |
| @ICM517 | <i>Ultimate Surge and Power Protection</i> |